

[illegible]

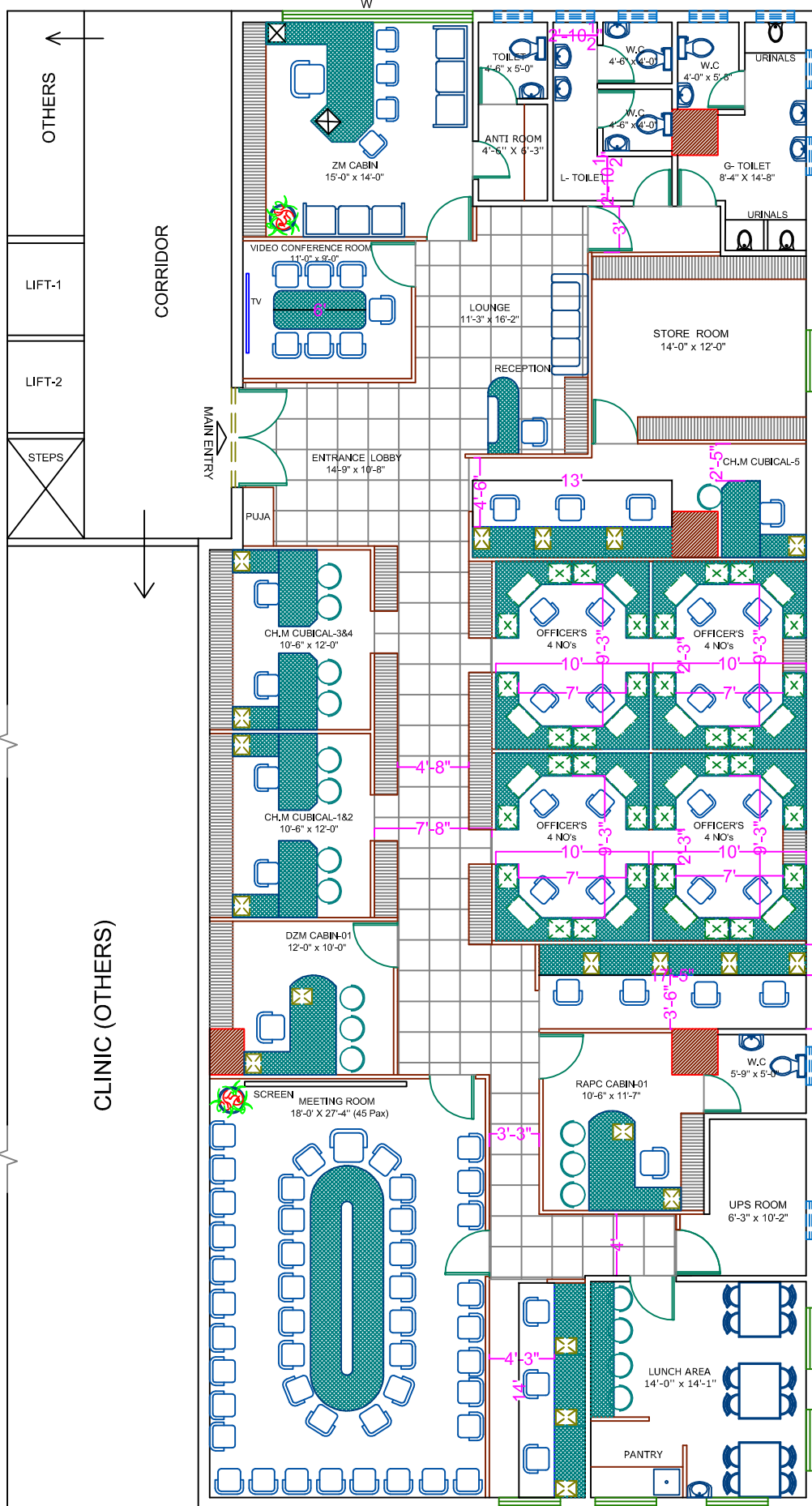

INDEX:

- 1) ZM HEAD CABIN -01 No
- 2) D.Z.M CABIN -01 No
- 3) CH.MANAGER CUBICAL -05 No's
- 4) RECEPTION / SECURITY -01 No
- 5) WORK STATION-27 No's

TOTAL STAFF = 27 No's.

- 6) MEETING ROOM - 45 Pax.
- 7) SUB STAFF -01 No's
- 8) LUNCH/ PANTRY ROOM -01 No
- 9) STAFF TOILE(L+G+ZM+AGM): 2+1+1+1 WC
- 10) UPS -01 No
- 11) RAPC CABIN -01 No
- 12) RECORD ROOM -01 No

TOTAL AREA = 3671 Sq. Ft.

1. THIS DRAWINGS IS THE PROPERTY OF THE ARCHITECT AND SHALL NOT BE COPIED WITHOUT HIS PERMISSION.
2. DISCREPANCIES FOUND IN THE DRAWING SHALL BE BROUGHT TO THE ARCHITECT'S NOTICE IMMEDIATELY.
3. DRAWINGS SHALL BE READ AND SHOULD NOT BE SCALED.

PROJECT :

**PROPOSED INTERIOR'S FOR
INDIAN BANK
NEW ZONAL OFFICE
MALKAJIRI ZO
AT KUKATPALLY.**

DRG TITLE :

**INTERIOR LAYOUT PLAN
SECOND FLOOR**

DESIGNED BY: FA
DRAWN BY: GHAYAN
CHECKED BY : FA
DATE : 15-11-2025
SCALE : NTS

OPTION - 13

NORTH :

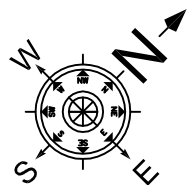

ARCHITECT:

FIROZ AHMED, M.Arch.,

H.NO 13-6-436/A/33,
LAKSHMI APARTMENTS,
2nd FLOOR, 301, LAKSHMI NAGAR
PILLAR NO.68, MEHIDIPATNAM,
HYDERABAD-028.

CELL: 98481 49737

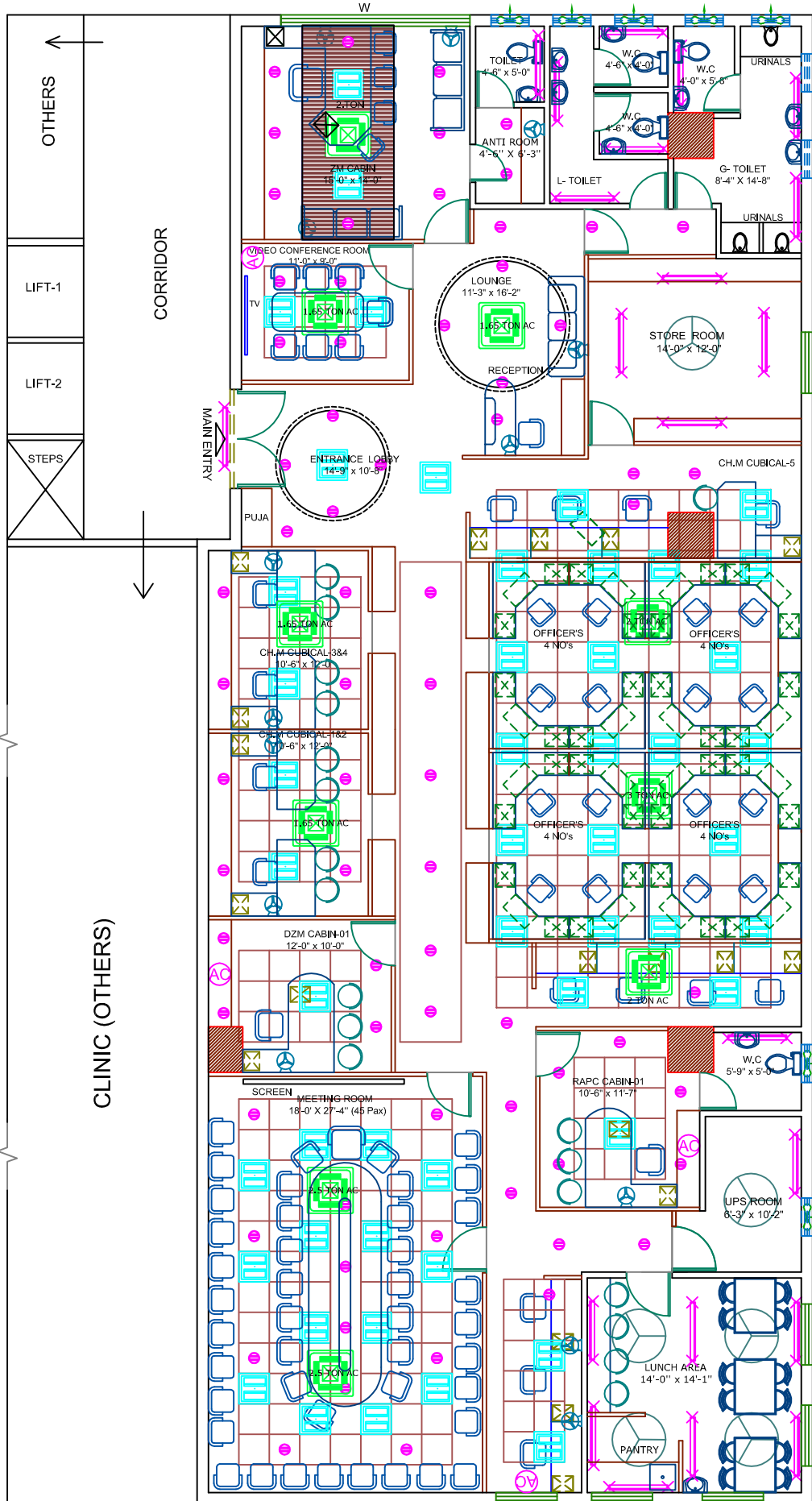

INDEX:

- 1) ZM HEAD CABIN -01 No
- 2) D.Z.M CABIN -01 No
- 3) CH.MANAGER CUBICAL -05 No's
- 4) RECEPTION / SECURITY -01 No
- 5) WORK STATION-27 No's

TOTAL STAFF = 27 No's.

- 6) MEETING ROOM - 45 Pax.
- 7) SUB STAFF -01 No's
- 8) LUNCH/ PANTRY ROOM -01 No
- 9) STAFF TOILE(L+G+ZM+AGM): 2+1+1+1 WC
- 10) UPS -01 No
- 11) RAPC CABIN -01 No
- 12) RECORD ROOM -01 No

TOTAL AREA = 3671 Sft.

1. THIS DRAWINGS IS THE PROPERTY OF THE ARCHITECT AND SHALL NOT BE COPIED WITHOUT HIS PERMISSION.

2. DISCREPANCIES FOUND IN THE DRAWING SHALL BE BROUGHT TO THE ARCHITECT'S NOTICE IMMEDIATELY.

3. DRAWINGS SHALL BE READ AND SHOULD NOT BE SCALED.

PROJECT :

PROPOSED INTERIOR'S FOR
INDIAN BANK
NEW ZONAL OFFICE
MALKAJIRI ZO
AT KUKATPALLY.

DRG TITLE :

INTERIOR LAYOUT PLAN
SECOND FLOOR

DESIGNED BY: FA
DRAWN BY: GHAYAN
CHECKED BY : FA
DATE : 17-11-2025
SCALE : NTS

OPTION - 13

NORTH :



ARCHITECT:

FIROZ AHMED, M.Arch.,

H.NO 13-6-436/A/33,
LAKSHMI APARTMENTS,
2nd FLOOR, 301, LAKSHMI NAGAR
PILLAR NO.68, MEHIDIPATNAM,
HYDERABAD-028.

CELL: 98481 49737

S.No	Item	Qty.	Unit	Rate in Rs.	Amount (Rs.P)
A	INTERIOR FURNISHING (CONTRACT WORK)				
1	Providing and fixing ENTRANCE DOOR(WITH TOUGHENED GLASS) Shall be 2'-6" wide Double leaf glass shutter. Door shutter made up of 12mm thick SGG SECURIT/AIS STRONGLAS- impact resistance glass with pencil polish edges all around. Etching details for glass door as per design, floor spring, bottom lock, SS brushed handle of 2'0" long 1" dia on both sides. refer section-5 for specifications, patch fittings etc. as directed by Bank / Architect. complete as shown in drawing. (Bank logo to be etched on glass shutter and other etching to be done on fixed glass as shown in the drg.)				
	a. Main Entrance Door	43.00	Sft		
	b. Lobby Fixed Partition	20.00	Sft		
2	Providing and fixing FULL HEIGHT PARTITION with (Half GLASS in double skin of 9mm thk.BWR grade ply with 1.0mm thk shell finish laminate on both sides fixed to natural melamine polished Beach wood bottom, middle and top rail of 3" x 2" and concealed Salwood verticals of 2" x 2" at not more than 4'-0" apart including fitting door frame where indicated with beach wood frame of 4" x 2" complete as shown in drawing. shall be of natural melamine polished beach wood, above 3'-0" with 6mm plain float glass with etching fixed to 2"x3" beach wood Vertical/ horizontals and 12mmx12mm BW beading, all in natural melamine mate polished, incl. fitting door frame where indicated with beach wood frame of 4" x 2" complete as shown in drawing. (Verticals to go upto the RCC roof for support, but measurement rate shall be made only upto the false ceiling only and shall not incl. the door shutter which is a seperate item).	176.00	Sft		
3	Providing and fixing FULL HEIGHT PARTITION with (Full GLASS in double skin of 9mm thk.BWR grade ply with 1.0mm thk shell finish laminate on both sides fixed to natural melamine polished Beach wood bottom, middle and top rail of 3" x 2" and concealed Salwood verticals of 2" x 2" at not more than 4'-0" apart including fitting door frame where indicated with beach wood frame of 4" x 2" complete as shown in drawing. shall be of natural melamine polished beach wood, above 3'-0" with 6mm plain float glass with etching fixed to 2"x3" beach wood Vertical/ horizontals and 12mmx12mm BW beading, all in natural melamine mate polished, incl. fitting door frame where indicated with beach wood frame of 4" x 2" complete as shown in drawing. (Verticals to go upto the RCC roof for support, but measurement rate shall be made only upto the false ceiling only and shall not incl. the door shutter which is a seperate item).	765.00	Sft		
4	LOW HEIGHT with DOUBLE SKIN (4'-0" ht.),as per 2 above ,with wood based Assam / Andaman teak wood / equivalent solid wood of 50mm x 50mm (2" x2") verticals @ 600mm to 900 mm (2'-0" to 3'-0") intervals spacing should not be more than 600mm (2'-0") intervals) with the skin on both sides made up of 9mm BWR ply wood finish with 1.0mm laminates up to 3'-0" ht & above that 14"ht 6mm thk etched glass fixed to 2"x3" beach wood Vertical/ horizontals and 12mmx12mm BW beading, all in natural melamine mate polished Complete as shown in drawing.	650.00	Sft		

S.No	Item	Qty.	Unit	Rate in Rs.	Amount (Rs.P)
5	Providing and fixing FULL HEIGHT PARTITION (Solid) in double skin of 9mm thk. BWR grade ply with 1.0mm thk shell finish laminate on both sides fixed to natural melamine polished Beach wood bottom, middle and top rail of 3" x 2" and concealed Salwood verticals of 2" x 2" at not more than 4'-0" apart including fitting door frame where indicated with beach wood frame of 4" x 2", complete as shown in drawing. (Verticals to go upto the RCC roof for support, but measurement rate shall be made only upto the false ceiling only and shall not incl. the door shutter which is a separate item).	665.00	Sft		
6	Providing and fixing ZONAL MANAGER TABLE (8'-0" X 3'-0") as per shape shown in drawing, with side table and 2no. drawer unit in natural melamine polished TW frame of 3"x 1.5" with 18mm thick BWR 303 ply verticals and horizontals with 0.8mm thk shell finish laminate, 12mm thk plain glass on table top as per shape, with wooden beading to all exposed edges of ply, with two coats of synthetic enamel paint incl. all approved accessories like drawer and keyboard sliders, locks, handles etc. with all internal surfaces of the table with 0.8mm thick laminate on plywood after one coat of primer, complete as shown in the drawing.	1.00	No		
7	Providing and fixing DZM /RAPC TABLE (6'-6" X 3'-0") as per shape shown in drawing, with side table and 2no. drawer unit in natural melamine polished TW frame of 3"x 1.5" with 18mm thick BWR 303 ply verticals and horizontals with 0.8mm thk shell finish laminate, 12mm thk plain glass on table top as per shape, with wooden beading to all exposed edges of ply, with two coats of synthetic enamel paint incl. all approved accessories like drawer and keyboard sliders, locks, handles etc. with all internal surfaces of the table with 0.8mm thick laminate on plywood after one coat of primer, complete as shown in the drawing.	2.00	No		
8	FRONT/ BACK OFFICER TABLES (5'-0" X 2'-6") with side table :Officer counter table (curve / straight) of 5'-0" length as per shape shown in drawing, made out of 18 mm 303I ply with edges fixed with 12mm teak wooden lipping, having clerical table top 2'-6" from the ground level & 2'-9" clear top width, with 18mm thk. commercial ply with 1mm thk. laminate, as per shape and size, Each unit shall be provided with a sliding key board tray 2'-3" of wide with sliders, cupboard below the drawer with locking arrangements aluminum handle, brass hinges etc the front back & top surface shall be laminated with 1.0mm thick approved laminate. The internal surface shall be painted with two coats of enamel paint (VANILLACREAM, CODE -3229) of Asian paints, over a coat of primer. Provision for c.p.u stand 1'-0" x2'-0" & footrest of size 75mmx 38mm shall be made at the bottom. Wire manager shall be provided at the corner of the counter top. All exposed edges of the block shall be provided with teak wooden beading (3"x1" front side and 1"x 3/4" inner side) and polishing done etc. complete as shown in drawing.	5	Nos.		
8a	Providing and fixing CLERICAL's TABLE (5'/4'-6" X 2'-6") with out side table but with a Drawer unit position as per shape shown in drawing, in 18mm thick BWR 303 ply verticals and horizontals with 1.0 mm thk shell finish laminate with Wooden beading incl all accessories like sliders, locks, handles etc., all internal surfaces of the table, with 0.8mm thick laminate complete as per drawing.	0.00	Nos.		

S.No	Item	Qty.	Unit	Rate in Rs.	Amount (Rs.P)
9	CLERICAL / OFFICER (5'-0"X 5'-0") L.TYPE table :Table tops of size 1500mm X 750mm (5'-0"X2'-6") made out of 19 mm BWR ply with 1.0mm thk laminated (approved colour and shade), fixed with edges fixed with beach wood lipping, (2'-6") 750mm from the ground level. it will have a side table of size 1050mm X 375mm (3'-6" x 1'-3"), Each unit shall be provided with a sliding key board tray (2'-3") 675mm of wide with telescopic drawer sliders, cupboard below the with locking arrangements SS handle, brass hinges etc the front, back & side surface shall be laminated with 1.0mm thick laminate. The internal surface shall be painted with two coats of enamel paint with approved colour and shade, over a coat of primer. Provision ready made CPU stand, key board & footrest of size 75mmx 38mm shall be made at the bottom. with beach wood, wire manager shall be provided at the corner of the counter top.	16	C.T		
10	CONFERENCE TABLE (4'-9" Wide) oval shape with glass at the centre top :Table as per shape shown in drawing, made out of TW legs (4"X3") verticals (4no) & horizontals (4no) tie up at top, 12mm plain flot glass with Acid wash etching to be done with edge full rounding smoothly. Provision for footrest of size (3"X2" shall be made at the bottom (-4"..in natural melamine polished TW frame of 3"x 1.5" with 18mm thick BWR 303 ply verticals and horizontals with 0.8mm thk shell finish laminate,	16.00	Rft		
11	VIDEO CONFERENCE TABLE (6'-0"X 2'-6") :Table as per shape shown in drawing, made out of TW legs (4"X3") verticals (4no) & horizontals (4no) tie up at top, 12mm plain flot with Acid wash etching to be done with edge full rounding smoothly. Provision for footrest of size (3"X3" shall be made at the bottom (-6").. All exposed teak wooden to be matt mellamine polishing to be done etc. complete as shown in drawing.	1.00	Nos.		
10	WORK STATION TABLE'S (counter-2'-0" wide) With Drawer: counter table (Chanfer / stright) of 4'-6" length as per shape shown in drawing,in natural melamine polished TW frame of 3"x 1.5" with 18mm thick BWR 303 ply verticals and horizontals with 0.8mm thk shell finish laminate, 12mm thk plain glass on table top as per shape, with wooden beading to all exposed edges of ply,with two coats of synthetic enamel paint incl. all approved accesories like drawer and keyboard sliders, locks, handles etc. with all internal surfaces of the table with 0.8mm thick laminate on plywood after one coat of primer, complete as shown in the drawing	45.00	Rft		
11	RECEPTION Counter: Counter table (curve / stright) of 5'-0"X2'-0" length as per shape shown in drawing, made out of 18 mm commercial ply with edges fixed with 12mm teak wooden lipping, having clerical table top 2'-6" from the ground level & 2'-9" clear top width, with 18mm thk. commercial ply with 1mm thk. laminate, as per shape and size, the front back & top surface shall be laminated with 1.0mm thick approved laminate.The internal surface shall be painted with to coats of enamel paint (VANILLACREAM, CODE -3229) of Asian paints, over a coat of primer. All exposed edges of the block shall be provided with teak wooden beading (3"x1"front side and 1"x 3/4" inner side) and polishing done etc. complete as shown in drawing.	1.00	Nos		
12	Providing and fixing SUB STAFF / Printer Table / Cash Counting / Lunch platform.. wooden beading in 18mm thick BWR ply with 1.0mm thk shell finish laminate on top fixed to with intermediate spaced not more than 30" apart, complete as shown in the drawing. All exposed ply and wood surfaceswith 0.8mm thick laminate, (Measurement will be made as per surface area of table)	18.00	Sft		

S.No	Item	Qty.	Unit	Rate in Rs.	Amount (Rs.P)
13	Providing and fixing GENERAL CUPBOARDS in 18mm thk BWR ply verticals and horizontals with 18mm thk BWR ply shelves with battened shutter in 12mm thk BWR ply with 0.8mm thk shell finish laminate on all external exposed surfaces with shutters fixed with auto closing hinges at not more than 2'-0" apart inclusive all approved accessories like handles, cupboard locks, tower bolts etc., complete as shown in the drawing. All internal exposed ply surfaces with 0.8mm thick Laminate and all exposed edges of ply to be fixed with Wood beading. (Measurement will be made on elevation area of cupboard irrespective of depth)	286.00	Sft		
14	Providing & fixing OPEN display SHELF in ZM/ DZM/ RAPC /Reception Cabin with 18mm thk ply vertical & horizontal 12mm thk plain glass with edge rounding shelf in between as per design 1mm thk laminate or all the exposed surface (outside, inside, side) the cupboard should be 10"/12" deep.	54.00	Sft		
15	Providing and fixing 12 mm th. SOFT BOARD on 12mm th. BWR ply with cloth covering of not less than Rs.250/- per metre, complete incl. painting the rear surface of ply with two coats of synthetic enamel paint and providing TW beading all around.	86.00	Sft		
16	FALSE CEILING :Provided & fixing with Indian gypsum or equivalent suspended false ceiling (in any shape as shown in drawing) which includes providing and fixing G.I perimeter channels of 0.55mm thk having one flange of 20mm & another flange of 30mm & a web of 27mm along the perimeter of the ceiling, screw fixed to the brick wall with the help of nylon sleeves & screws, at 610 mm centers. as per manufacturers spec.s, taping of joints and finishing. finally the board are to be jointed and finished so as have a flush lock which includes filling & finishing tapered square edges of the boards with jointing compound, paper tape and with one coat of lappam perfectly to level the surface, complete. complete as shown in drawing.	2,006.00	Sft		
17	FALSE CEILING (GRID) : The grid false ceiling shall be provided in the Banking Hall, Manager's etc. the ceiling height and level shall be provided at the perimeter. The minimum height of the ceiling cavity should be 100mm. All service fittings integrated within the suspended ceiling must be independently supported from the ceiling grid by a structure designed for the purpose. Ceiling tiles: shall be armstrong fine figured classic lite RH99 of 16mm thickness. Suspension system: shall be of armstrong trulok silhouette reveal profile grid system with 15mm flanges incorporating 3mm central recess in global white with black reveal. silhouette main runners and cross tees to have mitred ends and "birdsmouth" notches to provide mitred cruciform junctions.	1,180.00	Sft		
18	Providing and fixing DRAWER UNIT (1'-2"x1'-6"x2'-6"ht.) in 18mm thick BWR 303ply, for drawers verticals and horizontals with 0.8mm thk shell finish laminate on all visible outer surfaces with drawer slides incl. all accessories such as handles, auto closing hinges, single key locking system for drawers, with 0.8mm thick laminate, complete as shown in the drawing.	1.00	Nos.		
19	GLASS PARTITION of work station (1'-9"x1 ht.) above Curve shape as per layout plan (with 12mm thk. glass) fixed to, with edge rounding and side partition with coping on the top at the every edge of the table. complete as shown in drawing.	15.00	Nos		

S.No	Item	Qty.	Unit	Rate in Rs.	Amount (Rs.P)
20	Providing and fixing water proof solid core FLUSH DOORS shutters 35mm thk (TW wood beading of 0.5" x 1.25" to be provided all around) of approved make as per ISI specifications and 1mm thk shell finish laminate on both sides with vision hole cutting with 6mm thk plain glass as indicated. The shutter shall be fixed to frame work, necessary hardware fittings like brass butt hinges, door closers, mortice locks, tower bolts, handles etc. of approved make, including all incidental and operational charges etc., complete.	205.00	Sft		
21	Providing and fixing GLASS DOOR with SS where indicated to partition frame work in 8mm thk plain float glass fixed in 4"x1.5" top, middle and side rails, 6"x1.5" bottom rail, all in natural melamine polished MT wood including all accessories of approved brand such as floor springs, brushed SS handles, locks, etc. including all incidental and operational charges etc., complete as shown in the drawing.	85.00	Sft		
22	Providing and fixing WALL PANELLING in any shape to columns and walls where indicated with 8mm thk BWR ply fixed to 1" x 2" salwood/ aluminium verticals and horizontals spaced not more than 2'-0" apart in both directions with 1mm thk shell finish laminate at any height, complete as shown in the drawing.	536.00	Sft		
23	providing and fixing Acoustical panelling for ceiling & walls in any shape where indicated with 12mm thk BWR ply fixed to 1" x 2" Aluminum / GI frame verticals and horizontals spaced not more than 2'-0" apart in both directions with 10/12mm th. SOFT BOARD on 12mm th BWR ply with cloth covering of not less than Rs.450/- per metre, as per different shades/ coloured fabric, complete as shown in the drawing.				
	a) Acoustical panelling for walls	0	Sft.		
24	VERTICAL VENETION BLINDS: Providing and fixing 100mm wide vertical blinds of mac make of approved range with louver made of polyester base fabric and providing with guardian tilter wand cord accessories like head channel, end control unit, tilt rod, tilter chain, carrier, space, bottom mechanism, cord, cord weight, installation, etc; of approved colour and texture. complete as per Bank / Architect direction.	130.00	Sft		
25	ROLLER BLINDS: Providing and fixing 100mm wide vertical blinds of mac make of approved range with louver made of polyester base fabric and providing with guardian tilter wand cord accessories like head channel, end control unit, tilt rod, tilter chain, carrier, space, bottom mechanism, cord, cord weight, installation, etc; of approved colour and texture. complete as per Bank / Architect direction.	100.00	Sft		
26	Painting to Ceiling & walls with lappam in two coats of Acrylic emulsion paint after appropriate surface preparation of one coat of primer.	4,406.00	Sft		
27	Painting to walls and ceiling with out lappam in two coats of Acrylic emulsion paint after appropriate surface preparation of one coat of primer.	2,100.00	Sft		
28	Painting to Rolling Shutters in two coats of synthetic enamel paint after appropriate surface preparation of one coat of primer.	140.00	Sft		

S.No	Item	Qty.	Unit	Rate in Rs.	Amount (Rs.P)
29	Providing and fixing covering to rolling shutter and shutters for covering electrical panel board, etc., with 18mm BWR ply with 1mm thick shell finish laminate of approved shade and make including painting of inside with primer and two coats of synthetic enamel paint, and providing teak wood beading to all exposed edges including all accessories hinges, handles, ballcatches, etc., complete.	56.00	Sft		
30	Providing and fixing PIGION HOLE , with 18mm BWR ply with 1mm thick shell finish laminate AND 1mm laminate for inner surfaces too of approved shade, providing teak wood beading to all exposed edges including all accessories hinges, handles, ballcatches, etc., complete.	12.00	Sft		
31	Pantry counter: Providing and fixing Pantry counter with Granite top and storage below (4'x 2'x 2'-9"ht.) with a SS. sink of 16"/ 18" and storage with 18mm BWR ply and laminate, complete incl. painting the rear surface of ply with two coats of synthetic enamel paint and providing TW beading all around.	16	Sft		
32	DINING TABLE (4'-0"X 2'-6"): Table as per shape shown in drawing, made out of TW legs (4"X3") verticals (4no) & horizontals (4no) tie up at top, 12mm plain flt with Acid wash etching to be done with edge full rounding smoothly. Provision for footrest of size (3"X3") shall be made at the bottom (-6").. All exposed teak wooden to be matt mellamine polishing to be done etc. complete as shown in drawing.	3.00	Nos.		
33	Providing & fixing Bank Name & Logo with SS / Brass letter as per shape, Size & thickness by the Architect or Banks including fixing the selection on the existing on panel or partition complete.	28.00	Sft		
34	PVC CEILING Provided & fixing PVC ceiling (in any shape as shown in drawing) which includes providing and fixing over existing gypsum board. as per manufacturers spec.s, complete as shown in drawing.	110.00	Sft		
35	WOODEN CEILING Provided & fixing wooden ceiling with 12mm ply with 1mm laminate, equivalent suspended false ceiling (in any shape as shown in drawing) which includes providing and fixing G.I perimeter channels of 0.55mm thk having one flange of 20mm & another flange of 30mm & a web of 27mm along the perimeter of the ceiling, screw fixed to the brick wall / partition with the help of nylon sleeves & screws, at 610 mm centers. as per manufacturers spec.s, complete as shown in drawing.	88.00	Sft		
36	Providing & fixing Whiteboard/ convertible or expandible board.	85	Sft.		
*	TOTAL AMOUNT for Interior works Zonal Office (A):				
*	Rupees				
	GST 18%				