

**ABSTRACT ESTIMATE FOR THE INTERIOR FURNISHING,**  
**ELECTRICAL, DATA CABLING AND AIR-CONDITIONING WORKS**  
**FOR BRANCH AT INDIAN BANK , DEVAKOTTAI BRANCH,**  
**(NEW PREMISES) , TAMILNADU.**

**SUMMARY SHEET**

<b><u>SL.NO</u></b> <b><u>BRANCH</u></b>	<b>Type of work</b>	<b>Amount Quoted (Rs.)</b>
1.	<b>Interior Works</b>	<b>Rs.</b>
2.	<b>Furnishing Works</b>	<b>Rs.</b>
3.	<b>Electrical Works</b>	<b>Rs.</b>
4.	<b>Data Cabling Works</b>	<b>Rs.</b>
5.	<b>Air Conditioning Works</b>	<b>Rs.</b>
	<b>TOTAL</b> (Excluding GST )	<b>Rs.</b>

Notice: TENDERERS MUST VISIT THE SITE AND INSPECT FOR THEMSELVES THE ACTUAL WORKS TO BE CARRIED OUT BEFORE SUBMITTING THE TENDER

TENDERERS MUST VISIT THE SITE, INSPECT AND SUBMIT A COMPETITIVE BID FOR THE BUY BACK OF THE EXISTING FURNITURES IN THE RESPECTIVE COLUMNS PROVIDED IN THE TENDER DOCUMENTS.

<b>PROPOSED INTERIOR FURNISHING WORK FOR INDIAN BANK - DEVAKOTTAI BRANCH</b>					
<b>( NEW PREMISES) – BILL OF QUANTITIES</b>					
<b>Sl.No</b>	<b>Particulars</b>	<b>Qty</b>	<b>Unit</b>	<b>Rate</b>	<b>Amount</b>
				<b>(Rs)</b>	<b>(Rs)</b>
	<b>INTERIOR WORKS</b>				
<b>I</b>	<b>BRANCH</b>				
<b>1</b>	<b>Full height partitions with glass panels for manager cabin:</b>				
	Supplying and fixing glazed partitions using aluminium section of size 2"x 2" frame work having 2'x2' square grid on both sides covered with 6mm ply wood of approved make and finished with 1.0mm thk lamination which is to be used as per the drawing mentioned. Partitions frame is to be fixed properly to the roof slab, wood lipping with <b>Teak wood finish</b> to be fixed to fix the <b>12mm thk glass</b> with etching for full height partition. A glazed door has to be provided as per the drawing with <b>door closer and locks of godrej make.</b> (the partitions area given below the false ceiling level cost includes for aluminium frame to be extended and fitted up to roof ceiling. <b>Doors</b> to be made out of <b>10mm thk glass</b> with etching as per the design glass with etching has to be fixed on aluminium channel and the aluminium frame shall be covered with <b>6mm plywood</b> with 1.0mm thk lamination which is to be used as per the drawing mentioned the cost include 5" brass hinges(4nos/door) and door handle as approved by architect.				
	<b>Partition size : (10'3"+9'3") X 8'6"</b>	<b>166</b>	/ Sq.ft		
<b>2</b>	<b>Glazed partitions with entrance door:</b>				
	Supply and fixing of first class <b>Burma teak wood</b> . Main frame specifications-4"x3".Supply and fixing burma teak wood door frame size 5"x2"side and top and 6"x2" at bottom, stainless steel 1'0" ht handles to be fixed on both sides with <b>door closer and lock of godrej make</b> . 12mm thk glass with edging is to be fixed on the door frame. Proper teak wood lipping is to be provided to fix the 12mm thk glass. Cost includes brass hinges 5"-4Nos with 10" brass tower bolt-2Nos. All round with locker polish of approved shade and colour.2" teak wood lipping is to be provided on outer frame all sides. <b>Door size (6'0"X7'0")</b>	<b>42</b>	/sq.ft		
<b>3</b>	<b>Cash cabin partition with Table</b>				
	Partition				

	Providing and fixing in position of <b>2"x2"</b> aluminium section (2feetx2feet grid)both side covered with <b>8mm thk</b> ply wood and finished with 1.0 mm thk lamination which is to be used as per the drawing mentioned. Cash cabin size is 5'0"x8'0". wood lipping with teak wood finish to be fixed to fix the <b>12mm thk glass</b> with etching for cash counter partition. Cash counter 7'0" ht consists of plywood/glass partition with provision of opening at customer side and clerical side as per drawing.				
	<b>Door</b> to be made out of aluminium channel and the aluminium frame shall be covered with 8mm plywood with1.0mm thk lamination with <b>godrej night latch and godrej door closer</b> . wood lipping with teak wood finish is to be used to fix . The cost includes 5" brass hinges-3Nos and door handle as approved by architect.				
	door size(2'6"x6'9")				
	Table height 2'6"				
	The table having 25mm thk machine made post formed top with side and front side drop made of 18mm thk ply wood and drawer units/shutter made of 18mm plywood. All exposed area is finished with 1.0mm thk lamination of which is to be used as per the drawing of approved make. For keyboard drawer and table drawers/shutters <b>set lock (godrej)</b> , stainless steel handles to be provided. Shutter is to be fitted with SS hinges of approved make to be provided for each clericals table. Front side edges of table/drops (clerical side) are to be finished with wood with teak wood finish painting with one coat of primer and two coats of paint after doing patty is to be undertaken inside the drawer/shutter/table inner side. Powder coated metal key board of good quality is to be provided.				
	25mm thk table machine made post formed top				
	5'0"x 2'6"- 1No	<b>1</b>	/ No		
	4'6"x 2'6"- 2No	<b>0</b>	/ No		
<b>4</b>	Front & side partition with door as per drawing				
	Front side <b>(5'0" X 4'6")</b>				
	Side partition <b>( 7'3" X 7'0")</b>	<b>120</b>	/sq.ft		
	Top side partition With Aluminum grills <b>(5'3" X 7'3")</b>				
	Wall side <b>(1'6" X 7'0")</b>				
	Rear side				
<b>5</b>	<b>Front pillar partition &amp; side partition with glass</b>				
	<b>(3'6" X 4'0") 10 Nos L.H.P :(5'0" X 5'0")</b>	<b>165</b>	/sq.ft		
<b>6</b>	<b>Full Height Partition with Glass Door:</b>				

	Supplying and fixing <b>PLYWOOD</b> partitions using aluminium section of size <b>2"x 2"</b> frame work having 2'x2' square grid on both sides covered with 6mm plywood of approved make and finished with 1.0mm thk lamination which is to be used as per the drawing mentioned. Partitions frame work to be fixed properly to the roof slab. A glazed door has to be provided as per the drawing with door closer and locks of Godrej make. <b>Doors</b> to be made out of <b>8mm</b> thk glass with etching as per the design glass with etching has to be fixed on aluminium channel and the aluminium frame shall be covered with 6mm plywood with 1.0mm thk lamination which is to be used as per the drawing mentioned. The cost include 5" brass hinges (4 nos) and door handle as approved by architect. Door size 3'0"X 7'0"				
	<b>Partition size :</b>				
<b>a</b>	Plywood Partition with <b>one side lamination and other side painting (8'0"+20'0") x 11'6"</b>	<b>322</b>	/sq.ft		
<b>b</b>	Plywood Partition with <b>double side lamination (6'0" X 11'6") ded (6'0"X 7'0")</b>	<b>27</b>	/sq.ft		
<b>7</b>	<b>False ceiling:</b>				
<b>a</b>	Supplying and Erecting of Saint Approved make Gypsum board false ceiling at different heights as per drawing and Framework shall be made with "Gyrpoc " G.I. Section. Perimeter shall be fixed around the wall and partition of size 20 x 28 x 30 x 0.5 thick / Ceiling angle of size 25 x 10 x 0.5 thick shall be suspended from structural soffit with 1220 c/c distance on both direction and fixed with soffit cleat of size 27 x 37 x 25 x 1.6 thick and rawl plug / Intermediate channel of size 15 x 45 x 15 x 0.9 thick to support the ceiling section / Ceiling section of size 80 x 26 x 51 x 0.5 thick shall be connected to the intermediate section at 457mm c/c with connecting clip of size 2.64 diameter. 12.5mm thick Gypsum plain board to be fixed on the ceiling section with drywall screws at 230mm c/c on both direction. Gypsum board joints shall be connected with fibre tape and joints to be finished with putty, the putty shall be applied fully on the gypsum board area. Cost include 2 coats of emulsion paint and 1 coat of primer, cutout opening for light fittings, stepping, box opening, provision for hidden lights arrangements. Cost include wastage, hardwares, tools, lead, lift, loading, unloading charges, labour charges, transport and etc.				
	Note: Measurements shall be made flat area and verticals in SFT.	<b>1328</b>	/ sq.ft		
<b>8</b>	<b>Wicket door : 2'9" x4'0"</b>	<b>15</b>	/sq.ft		
<b>9</b>	<b>Painting</b> Entrance grill gate and Rolling Shutter etc.,				

	using <b>synthetic enamel paint</b> two coats of approved colour including all frameworks and related elements after removing the existing paint with sand paper and thereafter cleaning the surface including all labour charges, material charges etc complete.	<b>270</b>	/sq.ft		
<b>10</b>	<b>Wall/ column paneling:</b>				
	Aluminum section of size 2"x1" (grid 2'0"x2'0") frame work and covered with <b>8mm commercial plywood</b> (one side fixing) finished in lamination. The paneling area given below the false ceiling level. Cost includes for aluminum frame to be extended and fitted up of roof ceiling. Size : CP: (5'0"+5'0"+2'0") x 8'0" + W.P (4'9" x 8'0")	<b>0</b>	/sq.ft		
<b>11</b>	Providing and fixing <b>Cheque Drop Box</b> of size				
	<b>(1'6" x 1'6"x 1'0")</b>	<b>2</b>	/ No		
<b>12</b>	Providing and fixing <b>Roller blinds</b> for all windows Colour and materials selection by the Architect, Rates including material cost and labour charges etc. complete.	<b>163</b>	/sq.ft		
	<b>(5'6"X 5'0") X 5 Nos + (5'0"X5'0") X 1 No</b>				
<b>13</b>	<b>Making a temporary arrangements for seating of officers during course of civil works and furnishing in such a way they no hindrance observed for regular furnishing activities. Arrangements to be made in full coordination with branch civil works, electricals , A/C works.</b>	<b>0</b>	/Sq.ft		
<b>14</b>	<b>Dismantling the old Furnishing like Full height glass partition , Full height partition, Full height and Low height (wooden items) Storage units, Running counters, etc.</b>	<b>0</b>	/No		
	<b>TOTAL (I)</b>				
	(Excluding GST )				

**PROPOSED INTERIOR FURNISHING WORK FOR INDIAN BANK - DEVAKOTTAI  
BRANCH (NEW PREMISES) – BILL OF QUANTITIES**

Sl.No	Particulars	Qty	Unit	Rate (Rs)	Amount (Rs)
	<b>FURNISHING WORKS</b>				
<b>1</b>	<b>Clerical/officer table-25mm thk Machine made post formed table top and side table top</b>				
	Table height 2'6"				
	The table having 25mm thk machine made post formed top with side and front side drop, bottom base made of 18mm thk plywood and drawer units /shutter made of 18mm plywood. All exposed area is finished with 1.0mm thk lamination of which is to be used as per the drawing of approved make. For keyboard drawer and table drawers/shutters set lock (godrej), stainless steel handles to be provided. Shutter is to be fitted with SS hinges of approved make to be provided for each clericals table. Front side edges of table/drops(clerical side) are to be finished with wood with teak wood finish painting with one coat of primer and two coats of paint after doing patty is to be undertaken inside the drawer/shutter/table inner side. For the customer side of clerical table 10mm glass partition with edging of 1'3" ht to be fixed above the table using metal clamp to be fixed on side partitions /front pillar partition to be fixed between tables. The front pillar partition is to be made with 2"x 2" aluminium section both side covered with 6mm thk plywood and finished with 1.0mm thk lamination as per drawing. The last table –side partition size 4'6" htx4'0" customer side and 3'6" ht clerical side supported with 2"x 2" aluminium section both side covered with 6mm thk plywood and finished with 1.0mm thk lamination as per drawing at the bottom and at top table 10mm thk edged glass fixed with metal clamp.				
	Table with 25mm P/F table top 6'0" X 2'6" - 1 No (B.M)	1	/ No		
	Table with 25mm P/F table top 4'6"X2'6"- 4 Nos (O.T-2 to O.T-3,4, C.T-4)	0	/ No		
	Table with 25mm P/F Side table top (3'6"x 1'6") (Mr.,C/C)	2	/ No		
	Table with 25mm P/F table top (4'0"X 2'6") – 4 Nos (C.T-1,2,3, O.T-1)	8	/ No		
	Table with 25mm P/F table top (7'0"X 2'6") – 1 No (GLA)	1	/ No		
	Table with 25mm P/F table top (4'0"X 2'0") – 1 Nos	1	/ No		
	Table with 25mm P/F table top (3'0"X 2'0") – 1 No	0	/ No		

<b>2</b>	<b>Storage Unit(Full / low height) :</b>				
	Providing and fixing 1'6" wide storage unit made of 18 mm plywood finished with 1 mm lamination of approved colour & pattern on top and all visible sides with shelves. Inside painting with one coat of primer and two coats of paint after doing patty is to be undertaken . All exposed edges are finished with hardwood lipping. Provided openable shutters with SS handles, lock and auto closing hinges as per design.				
	<b>F.H.S :</b>	<b>0</b>	/sq.ft		
<b>3</b>	<b>Fixing of glass</b>				
	Glass with all side edging is to be fixed in between pillar partition on the table top using SS clamp as per drawing.				
	12mm thk glass of size <b>4'6" X 2'0"</b> - 1 No	<b>0</b>	/ No		
	12mm thk glass of size <b>4'0" X 2'0"</b> - 8 Nos	<b>8</b>	/ No		
	12mm thk glass of size <b>7'0" X 2'0"</b> - 1 No	<b>1</b>	/ No		
	12mm thk glass of size <b>3'0" X 2'0"</b> - 2 Nos	<b>0</b>	/ No		
	10mm thk glass for table top <b>6'0" X 2'6"</b> - 1 Nos	<b>1</b>	/ No		
<b>4</b>	<b>Writing ledge/challon holder</b>				
	Fabricating and fixing of writing ledge and challon holder made of 10mm glass supported with plywood stand finished with lamination glass edges beveled to half round safe suitably supported on ply wood as per drawing.	<b>1</b>	/No		
<b>5</b>	<b>Notice board</b>				
	Fabricating and fixing of notice board made of teak wood frame filled with soft board and covered with fabric, a color of the fabric to be math the décor the outer frame of the notice board is to be finished with locker polish.	<b>1</b>	/ No		
	<b>(size 4'0" x 3'0")</b>				
<b>6</b>	Providing and fixing <b>Entrance Rolling shutter coverage box with</b> Aluminum section of size 2"x1" (grid 2'0"x2'0") frame work and covered with <b>Alco Panel sheet</b> of size (9'0"X 5'0" ) + (1'6"X3'0" ) X 2 Nos	<b>54</b>	/sq.ft		
	<b>TOTAL (I)</b>				
	(Excluding GST )				

**PROPOSED ELECTRICAL WORK FOR INDIAN BANK -DEVAKOTTAI BRANCH ( NEW PREMISES) - SCHEDULE OF QUANTITIES**

No	Description of work	Size/qty	Unit	Rate	Amount
<b>I</b>	<b>BRANCH</b>				
<b>1</b>	Supply and laying of following size of original (Approved make )PVC insulated copper wire in suitable PVC conduit of 2mm thk with necessary PVC accessories like elbows, bends etc, necessary clampings				
<b>a</b>	4 x 6 sqmm + 1 x 4 sqmm from Main MCB DB to UPS input cost of 4 x 6sqmm wire & } 1 x 4 sqmm wire }				
	Cost of PVC conduit pipes }	<b>35</b>	/M		
	Laying/fixing charges }				
<b>b</b>	<u>BM cabin one AC machine each</u> Cost of 2 x 4 sqmm wire 1 x 1.5 sqmm wire				
	Cost of PVC conduit pipes	<b>40</b>	/M		
	Laying/fixing charges				
<b>c</b>	<u>Banking Hall 6 AC machine</u> Cost of 2 x 4 sqmm wire } 1 x 1.5 sqmm wire				
	Cost of PVC conduit pipes	<b>170</b>	/M		
	Laying/fixing charges				
<b>d</b>	2 x 4 sqmm + 1 x 2.5 sqmm from UPS output to UPS output main MCB DB & UPS output circuits DBs Cost of 2 x 4 sqmm wire & } 1 x 2.5 sqmm wire }				
	Cost of PVC conduit pipes } Laying/fixing charges }	<b>20</b>	/M		
<b>e</b>	3 x 2.5 sqmm from UPS output to circuit DBs to UPS points (Four circuits) Cost of 3 x 2.5 sqmm wire & } Cost of PVC conduit pipes ) Laying charges }				
	(UPS & RAW POWER CIRCUIT)	<b>490</b>	/M		

<b>2a</b>	Supply and fixing of 2 x 4 sq.mm and 1 x 2.5 sq.mm <b>(Approved make )</b> copper wire in PVC conduit of 2mm thk from change over switch to generator point	<b>50</b>	/M		
<b>b</b>	Supply and fixing of 15 A switch plug and socket with suitable surface mounted box. <b>(Approved make )</b>	<b>6</b>	/No		
<b>3a</b>	Supply and laying for 3.5 X 50 sq.mm aluminium armoured cable for EB meter to Main DB	<b>50</b>	/M		
<b>b</b>	Supply & fixing of <b>(Approved make)</b> following 8way 3phase vertical type double door <b>MCCB</b> DBs in suitable MS enclosures with necessary interconnection main <b>MCCB</b> DB				
	MS Enclosures -1No	<b>1</b>	/No		
	100Amps MCCB -1No	<b>1</b>	/No		
	63Amps 3pole MCB -4Nos	<b>4</b>	/No		
	SP 40Amps MCB -10Nos	<b>10</b>	/No		
<b>c</b>	UPS INPUT MAIN MCB DB <b>(Approved make )</b> with MS enclosure	<b>1</b>	/set		
	63Amps 4pole MCB				
<b>d</b>	UPS OUTPUT MAIN MCB DB <b>(Approved make )</b>				
	Double door single phase 8way with MS enclosure -1				
	40Amps 2pole MCB -1	<b>2</b>	/set		
	SP 10 Amps MCB -6				
<b>e</b>	Supply & fixing of <b>(Approved make)</b> following 8way three phase vertical type double door MCB DBs in suitable MS enclosures with necessary interconnection main MCB DB for lighting				
	MS Enclosures	<b>1</b>	/No		
	63 Amps 4 pole MCB	<b>1</b>	/No		
	SP 25 Amps MCB	<b>12</b>	/No		
<b>4a</b>	Change over with phase shifter Supply & Installation of 63Amps 4 pole change over switch for generator - <b>(Approved make )</b>	<b>1</b>	/No		

<b>b</b>	Supply & providing of 3 Phase indicating lamps (3Nos) in suitable box	<b>1</b>	/set		
<b>c</b>	Supply & fixing of 63Amps Auto Phase Selector switch for UPS Input	<b>1</b>	/set		
	<b>(Approved make )</b>				
<b>d</b>	Supply and laying of 2pair Telephone cable <b>(Approved make )</b> suitable PVC pipe/channel	<b>290</b>	/M		
	cost of cable				
	cost of PVC pipe				
	Laying charges				
<b>e</b>	Supply & installation/fixing of Modular type RJ11 Telephone sockets <b>(Approved make )</b>	<b>10</b>	/No		
<b>f</b>	Supply & installation/fixing of 20 pair krone box with Connectors including Temination Charges	<b>1</b>	/set		
<b>5a</b>	Supply, installation and testing of dedicated earth pit for UPS as per standard using 600mm x 600mm x 3mm copper thick. The rate should include excavation, salt and charcoal powder, brick work 450mm x 450mm, cast iron cover/plate etc of & providing of copper plate ear thing as per standard for dedicated earth pit for UPS	<b>1</b>	/set		
<b>b</b>	Supply & laying of 6sqmm copper wire within 20mm GI pipe from earth electrodes to the UPS	<b>55</b>	/M		
<b>6a</b>	Supply & fixing of 3Nos 6amp socket with 2Nos.6amp switch in suitable surface mounted box. - UPS Power <b>(Approved make )</b>	<b>19</b>	/No		
<b>b</b>	Supply & fixing of 1Nos 6amp socket with 1Nos.6amp switch in suitable surface mounted box for Wall Fan and Officer Table. - <b>(Approved make )</b>	<b>25</b>	/No		
<b>c</b>	Supply & fixing of 2Nos 6amp socket with 1Nos.15amp switch in suitable box for Raw Power- Modular type- <b>(Approved make )</b>	<b>6</b>	/No		

<b>7a</b>	Supply and fixing of original 4 x 4 sq.mm + 1 x 2.5 sqmm copper wire in PVC conduit of 2mm thick from Main MCB DB to generator change over and from changeover to lighting board	<b>40</b>	/M		
<b>b</b>	Supply and fixing 20A Metal clad plug and socket for AC unit	<b>8</b>	/No		
<b>8</b>	<b>Point wiring:</b>				
	Point wiring for light,fan, 6A switched sockets with (Approved make) 2R 1.5 Sqmm FRLS insulated multi strand single core copper conductor wire drawn in 20mm dia 2mm thick PVC conduit to be laid on false ceiling by clamping with GI clamps, concealed on wall and RCC roof etc with all accessories like conduit bends, junction boxes etc. The work also involves supply and fixing of 6A modular switch housed in manufacture's zinc passivated MS box to be concealed to wall.				
<b>a</b>	One light point controlled by one switch	<b>43</b>	/No		
<b>b</b>	Two light controlled by one switch	<b>7</b>	/No		
<b>c</b>	Fan point with fan hook	<b>9</b>	/No		
<b>d</b>	6A switch box sockets in the switch board itself	<b>8</b>	/No		
<b>e</b>	Supply and fixing of Calling bell with switch including Connection Charges, etc., complete.	<b>1</b>	/No		
<b>f</b>	Supply and installation of 2R 2.5 Sqmm FRLS multi strand copper wire drwn in 20mm PVC conduit 2mm thick to be laid concealed on wall between DBs and switch boxes including terminations at both ends <b>(UPS &amp; RAW POWER CIRCUIT)</b>	<b>560</b>	/M		
<b>9</b>	<b>LIGHT FIXTURE :</b>				
	(Approved Make)				

<b>a</b>	Supply of commercial Recess mounted 36W LED luminares comprises of CRCA housing powder coated in white the LED cluster are PMMA diffuser uniform glare-free light distribution suitable for 600mmx600mm ceiling and operating voltage 240V input current 0.140 – 0.160 AMP input wattage 33-37W	<b>21</b>	/No		
<b>b</b>	Supply of ISW LED Recess mounted down lighter comprises of aluminium dia cast housing and ring finished white powder coated with high translucent frosted PMMA diffuser operation voltage 240V input current 0.06-0.075 AMP input wattage 14.5-15.5W	<b>10</b>	/ No		
<b>c</b>	1 X 28 With Patti Light Fixture.	<b>16</b>	/ No		
<b>d</b>	48" Ceiling Fan of Approved make.	<b>9</b>	/ No		
<b>e</b>	Supply & fixing of Blue colour LED FLEXI Strip Light fittings in the stepped false ceiling area including the cost of wiring etc., complete.	<b>0</b>	/m		
<b>f</b>	Battern Holder with 11 Watts CFL Retrofit.	<b>2</b>	/No		
<b>g</b>	Wall mounted Fan Approved make : Crompton 450mm Full Body Metal	<b>13</b>	/ No		
<b>h</b>	Exhaust Fan Approved make.	<b>3</b>	/ No		
<b>TOTAL (I)</b>					
(Excluding GST )					

**PROPOSED DATA CABLING WORK FOR INDIAN BANK - DEVAKOTTAI  
BRANCH ( NEW PREMISES) - SCHEDULE OF QUANTITIES**

<b>S.No</b>	<b>Description of work</b>	<b>Qty</b>	<b>Unit</b>	<b>Rate</b>	<b>Amount</b>
<b>1</b>	Supply & laying of CAT 6 Data Communication cable in 2mm thk heavy duty 20mm dia PVC conduit and making holes in the partitions / wall all accessories as required (DLink)	<b>480</b>	<b>/ m</b>		
<b>2</b>	Supply & Installation, Testing & Commissioning of Modular type 1Nos of RJ45 Female Jack housed in PVC box with suitable Face plate fixing the same in the wall / partition with all accessories etc.,as required.	<b>16</b>	<b>/SET</b>		
<b>3</b>	Supply and fixing of 1M Mounting CAT -6 Cord	<b>16</b>	<b>/SET</b>		
<b>4</b>	Supply and fixing of 2M Mounting CAT -6 Cord	<b>16</b>	<b>/SET</b>		
<b>5</b>	Supply & Installation of 24 port SWITCH	<b>0</b>	<b>/SET</b>		
<b>6</b>	Supply & Installation of 24 port CAT 6 Jack Panel	<b>1</b>	<b>/SET</b>		
<b>7</b>	Supply & Installation of 9u Wall mounting Server rack	<b>1</b>	<b>/SET</b>		
	<b>TOTAL</b>				
	(Excluding GST )				

**PROPOSED AIR CONDITIONING WORK FOR INDIAN BANK -  
DEVEKOTTAI BRANCH (NEW PREMISES) - SCHEDULE OF**

	<b>BASIS OF DESIGN</b>				
	1. Area to be air conditioned	:	1328.00 Sq.ft		
	2. Outside Design conditions	:	100 F DB and 83 F		
	3. Inside Design conditions	:	75 F + 2 % DB and		
	Not exceeding 50%				
	4. Lighting Load	:	1 watts per Sq.ft		
	5. Equipment Load	:	9 Computers +		
	6. Occupancy Factor	:	45 persons		
	7. Fresh Air	:	One Air changes per		
	8. Power Supply	:	415 V, 50 Hz, 3 PH		
	9. Exposed Glass	:	To be shaded by using		
	10. Exposed Roof	:	To be insulated by 50		
			TF quality thermocole		
	<b>SCOPE OF WORK</b>				
<b>S.N</b>		<b>Size/</b>			
<b>O</b>	<b>Description of work</b>	<b>qty</b>	<b>Unit</b>	<b>Rate</b>	<b>Amount</b>
	<b>AIR CONDITIONING WORKS</b>				
1	Supply, installation, Testing and commissioning of indoor and outdoor split air conditioner with remote control, with 5 STAR INVERTER rating units including stabilizer (Make : Everest) and necessary civil works etc., The rate of units and is including the supply and laying of 3 mts of copper pipes with insulations, rubbers, white cements etc.,				
	MAKE: Voltas, Blue Star, Carrier.				

	2.0 TR- 5 for Customer Lobby, & Bankin	<b>0</b>	<b>NO</b>		
	1.5 TR- 1 for Customer Lobby	<b>0</b>	<b>NO</b>		
	1.0 TR-1 for Branch Manager,	<b>0</b>	<b>NO</b>		
2	ANCILLARY WORKS;				
	Supply and laying of copper pipes with rubber insulations, rubber, white cements, wall concealing works, etc.,				
	2.0 TR- 6 for Customer Lobby, & Banking Hall	<b>85</b>	<b>/ m</b>		
	1.5 TR- 1 for Customer Lobby, & Banking Hall	<b>0</b>	<b>/ m</b>		
	1.0 TR- 1 for Branch Manager Cabin	<b>15</b>	<b>/ m</b>		
3	Supply, installation, of Outdoor Stand with necessary civil works, etc.,	<b>7</b>	<b>NO</b>		
4	Supply, installation, of Stabilizer make : Everest and necessary Civil Works etc.,	<b>7</b>	<b>NO</b>		
4	Supply and laying of PVC Blue pipes for water drain from the indoor units with necessary wall concealing works, putty works, etc.,	<b>140</b>	<b>/ m</b>		
	<b>TOTAL</b>				
	(Excluding GST )				

**INDIAN BANK**  
**DEVAKOTTAI BRANCH**  
 (NEW PREMISES)

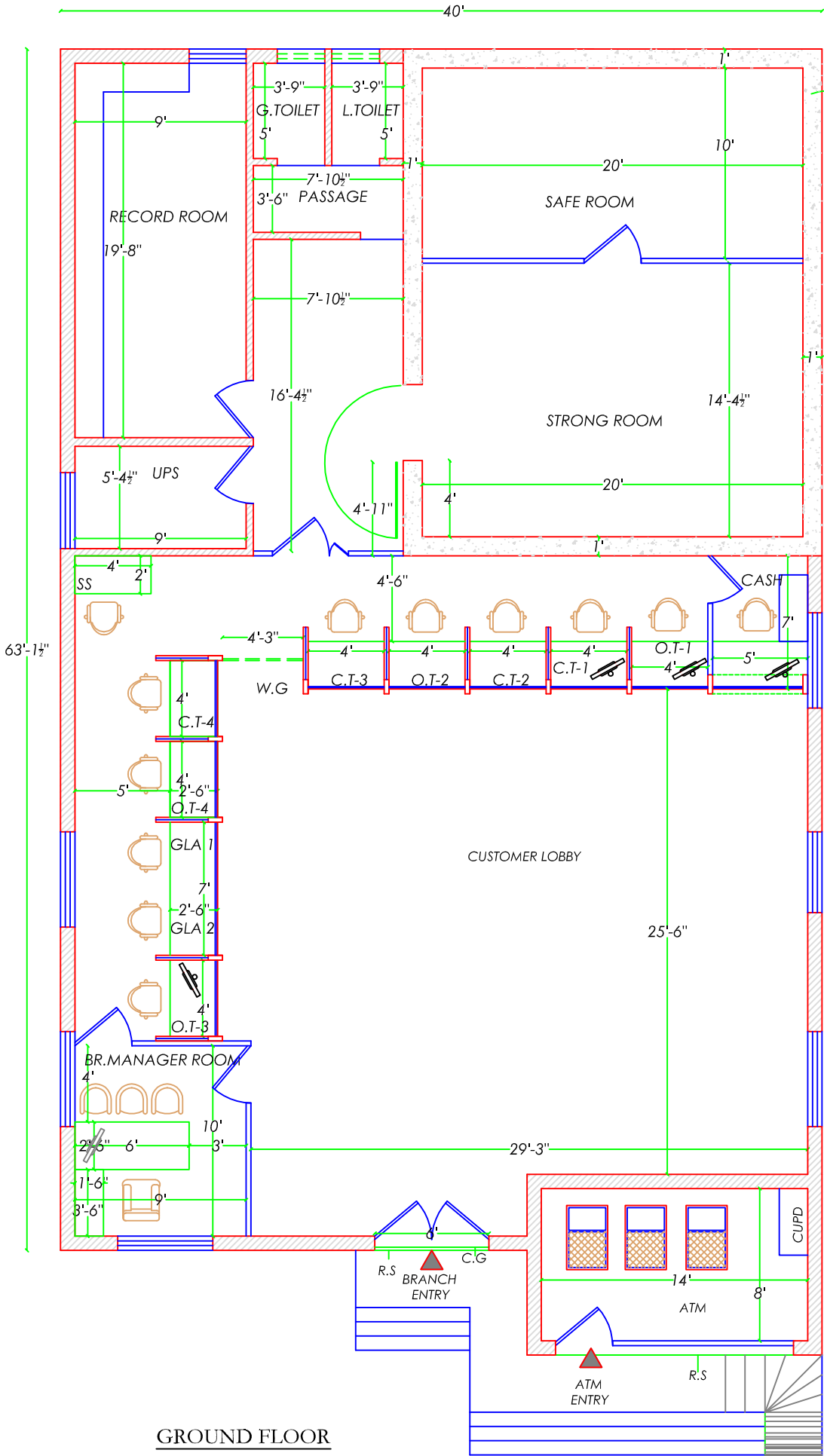

**STRONG ROOM SPECIFICATION**

M20 GRADE CONCRETE  
 WALLS : RCC 1:1.5:3 12" (30cm) thick  
 FLOOR : RCC 1:1.5:3 6" (30cm) thick  
 ROOF : RCC 1:1.5:3 12" (30cm) thick

STEEL 12mm Boreways  
 SPACING 15cm X 15cm C/C  
 VENTIATOR PLACED ABOVE 7'0" ht.

**NOTE :**

WINDOW SILL HEIGHT - 3'0"  
 LINTEL HEIGHT - 7'0"  
 ROOF HEIGHT LVL - 11'6"  
 ROOF BEAM BOTTOM LVL - 9'6"

**REFERENCE :**

FHGP- FULL HEIGHT GLAZED PARTITION  
 FHP - FULL HEIGHT PARTITION  
 F.H.S - FULL HEIGHT STORAGE  
 O.T -OFFICER'S TABLE  
 C.T -CLERICAL TABLE  
 G.L.A -GOLD LOAN APPRAISER  
 M.D - MAIN DOOR (6'0"X7'0")  
 D - DOOR (3'0"X7'0")  
 D2 - DOOR (2'6"X7'0")  
 W - WINDOW(6'0"X4'0")  
 V1 - VENTILATOR (2'6"X2'0")  
 C.P - COLUMN PANELING  
 R.S - ROLLING SHUTTER  
 C.G - COLLAPSIBLE GATE  
 W.G - WICKET GATE

**AREA DETAILS :**

Branch Carpet area : 2188.00 sq.ft  
 (Excluding toilet)  
 ATM Carpet area : 112.00 sq.ft

**TITLE**

**TENDER CONCEPT**

DRAWN	- R.M
JOB NO	- 111/ 24-25
DATE	- 09.02.2026
SCALE	- N.T.S.
SHEET NO	- 03

**MATHURA ASSOCIATES**  
 ARCHITECTURAL & STRUCTURAL CONSULTANT  
 INTERIOR DESIGNS - VALUERS - LANDSCAPE

Contact :  
 99658-81704  
 96006-31864

Proprietor :  
**Ar.D.MADHUKANNAN B.Arch.,AIIA.,FIV.,Mem.C.A.,**  
 REGISTERED ARCHITECT - COA  
 EMPANELLED ARCHITECT - INDIAN BANK  
 GOVT. REGISTERED VALUER - INCOME TAX  
 47-B Town Hall Road, 1st Floor, Madurai-625001.

**GROUND FLOOR**

**INDIAN BANK**  
**DEVAKOTTAI BRANCH**  
 (NEW PREMISES)

40'

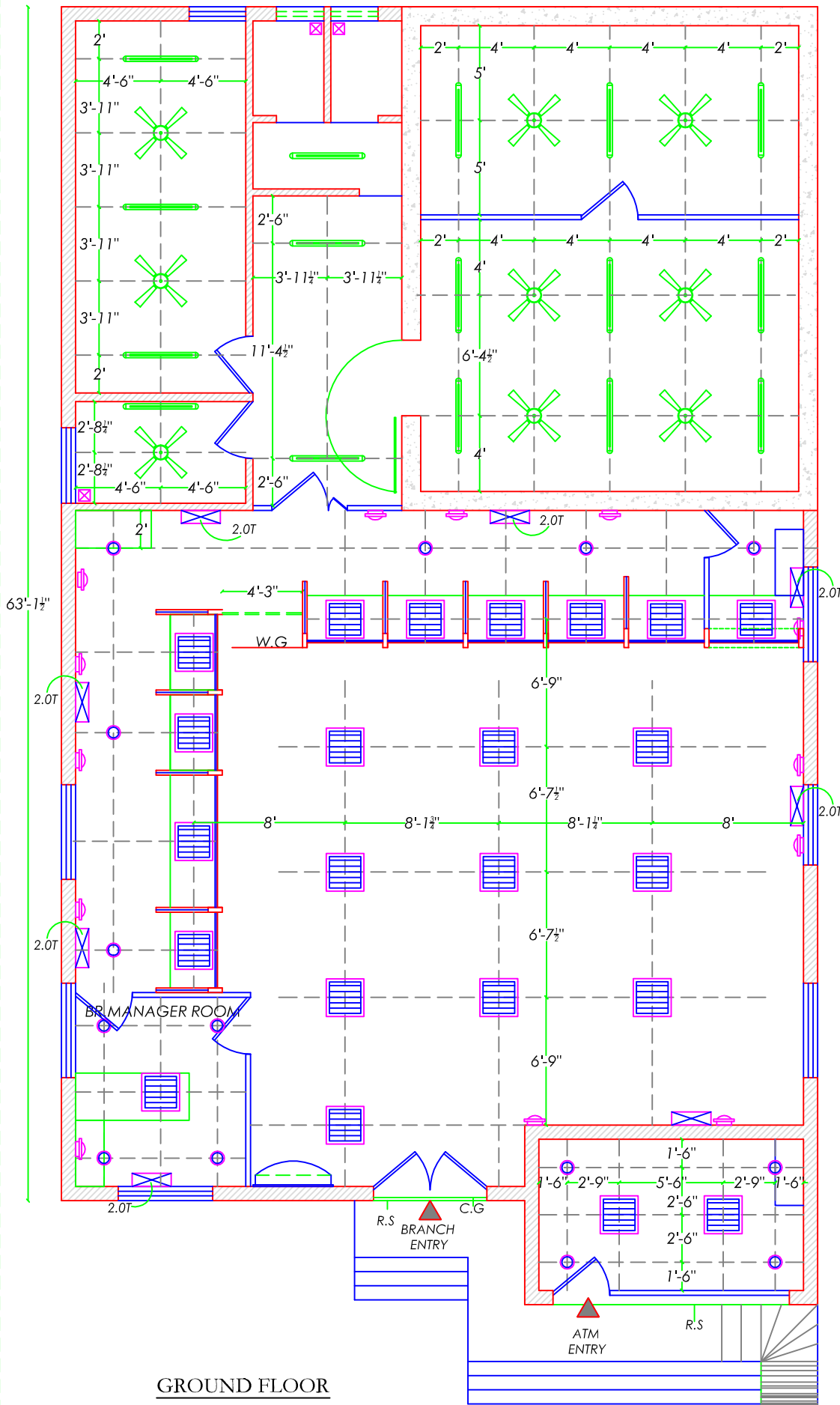

**NOTE :**  
 WINDOW SILL HEIGHT - 3'0"  
 LINTEL HEIGHT - 7'0"  
 ROOF HEIGHT LVL - 11'6"  
 ROOF BEAM BOTTOM LVL - 9'6"

- REFERENCE :**
- A/C - 1.0 Ton - 1+1 Nos  
A/C - 2.0 Ton - 6 Nos.
  - 4' Ceiling fan - 9 Nos
  - Wall mounted fan - 13 Nos
  - Recessed down light LED (2 x 18 W) - 10+4 Nos
  - Exhaust fan - 3 Nos
  - 2'x 2' LED Recessed 21+2 Nos
  - Tubelight - 16 Nos

**AREA DETAILS :**  
 Branch Carpet area : 2188.00 sq.ft  
 (Excluding toilet)  
 A/C Carpet area : 1328.00 sq.ft  
 ATM Carpet area : 112.00 sq.ft

**TITLE**  
**ELECTRICAL LAYOUT**

DRAWN	- R.M
JOB NO	- 111/ 24-25
DATE	- 09.02.2026
SCALE	- N.T.S.
SHEET NO	- 04

**MATHURA ASSOCIATES**  
 ARCHITECTURAL & STRUCTURAL CONSULTANT  
 INTERIOR DESIGNS - VALUERS - LANDSCAPE

Contact :  
 99658-81704  
 96006-31864

**Proprietor :**  
**Ar.D.MADHUKANNAN B.Arch.,AIIA.,FIV.,Mem.C.A.,**  
 REGISTERED ARCHITECT - COA  
 EMPANELLED ARCHITECT - INDIAN BANK.  
 GOVT. REGISTERED VALUER - INCOME TAX  
 Plot No.19/1,1st Floor, Agasthiyar Street, Opp.Road to Indus Hospital,  
 Viswanathapuram Extn., Madurai- 625014,Tamilnadu.

**GROUND FLOOR**