

- NOTES:-**
1. THIS DRAWING SHALL NOT BE SCALED. ONLY WRITTEN DIMENSIONS TO BE FOLLOWED.
 2. THIS DRAWING SHALL BE READ IN CONJUNCTION WITH RELEVANT LATEST ARCHITECTURAL AND STRUCTURAL DWG
 3. ALL SOIL AND WASTE PIPES SHALL BE PVC PIPES CONFORMING TO IS : 4985-2000 OR SWR 13592
 4. ALL FITTINGS LIKE BENDS, TEES ETC. IN DUCT FOR SOIL AND WASTE PIPE SHALL BE PROVIDED WITH DOORS.

- 300 X 300MM GULLY TRAP
- 450 X 450MM MANHOLE
- 900MM RAIN WATER HARVESTING PIT
- 900MM WASTE WATER SOAK PIT

- SPECIFICATION OF PIPES:**
- 50 ϕ PVC PIPE (6KG/SQ.CM)
 - 75 ϕ PVC PIPE (6KG/SQ.CM)
 - 110 ϕ PVC PIPE (6KG/SQ.CM)
 - 110 ϕ PVC PIPE (6KG/SQ.CM)
 - 160 ϕ PVC PIPE (6KG/SQ.CM)

- PLUMBING LEGENDS**
- UR - URINAL
 - IWC - INDIAN WATER CLOSET
 - EWC - EUROPEAN WATER CLOSET
 - WB - WASH BASIN
 - SH - SHOWER
 - CWS - COLD WATER SUPPLY
 - PS - PLUMBING SHAFT
 - WP - WASTE PIPE
 - SP - SOIL PIPE
 - RWP - RAIN WATER PIPE
 - PT - P TRAP
 - GT - GULLY TRAP
 - MH - MAN HOLE
 - WWSP - WASTE WATER SOAK PIT
 - RWHP - RAIN WATER HARVESTING PIT

- NOTES:-**
1. ROOF HEIGHT 3300 ROOF TOP TO TOP
 2. LINTEL HEIGHT 2100.
 3. SILL HEIGHT 750.
 4. WINDOW HEIGHT 1350.
 5. FLOOR AND CEILING FINISH - ROOF TOP TO TOP

COPYRIGHT:
All rights reserved. This work is copyright and cannot be or copied in any form or by any means (graphic, electronic or reproduced mechanical, including photocopying) without the written permission of nanda & associates. Any license, express or implied, to use the document for any purpose whatsoever is restricted to the terms of the agreement or implied agreement with nanda & associates

LEGEND:-

- 230MM, 115MM THK BRICK WORK
- R.C.C COLUMN

NORTH POINT :

AREA STATEMENT

PLOT AREA AS PER FMB - 4012.00 SQ.M

S.NO.	DESCRIPTION	AREA IN SQ.M	AREA IN SQ.FT
1	GROUND FLOOR	575.00	6,190.00
2	FIRST FLOOR	494.00	5,317.00
3	SHR	54.00	581.00
TOTAL AREA		1,123.00	12,088.00

- LEGENDS**
- SETBACK LINE
 - SITE BOUNDARY
 - BUILDING LINE
 - DRIVE WAY

CLIENT:
INDIAN BANK

PROJECT :
PROPOSED CONSTRUCTION OF INDIAN BANK'S RURAL SELF EMPLOYMENT TRAINING INSTITUTE AT KRISHNAGIRI, TAMILNADU.

DRAWING TITLE :
GROUND FLOOR & EXTERNAL DRAINAGE LAYOUT

- SCHEMATIC DRAWING
- WORKING DRAWING
- TENDER DRAWING
- AS BUILT DRAWING

SCALE : N.T.S	DATE : 04/04/2025	REV NC
DRAWN BY : RITIKA	CHECKED BY : Muni	01
JOB NO : 3045/25	DWG NO : ARC - SCH - 01	

ARCHITECT :

NANDA & ASSOCIATES ARCHITECTS

NO.36, SARASWATHI ILLAM, JANAKIRAM COLONY MAIN RD, JANAKIRAM COLONY, ARUMBAKKAM., CHENNAI - 600 106.
TEL: 044-23627400 E: mail:nandaarchitects@gmail.com

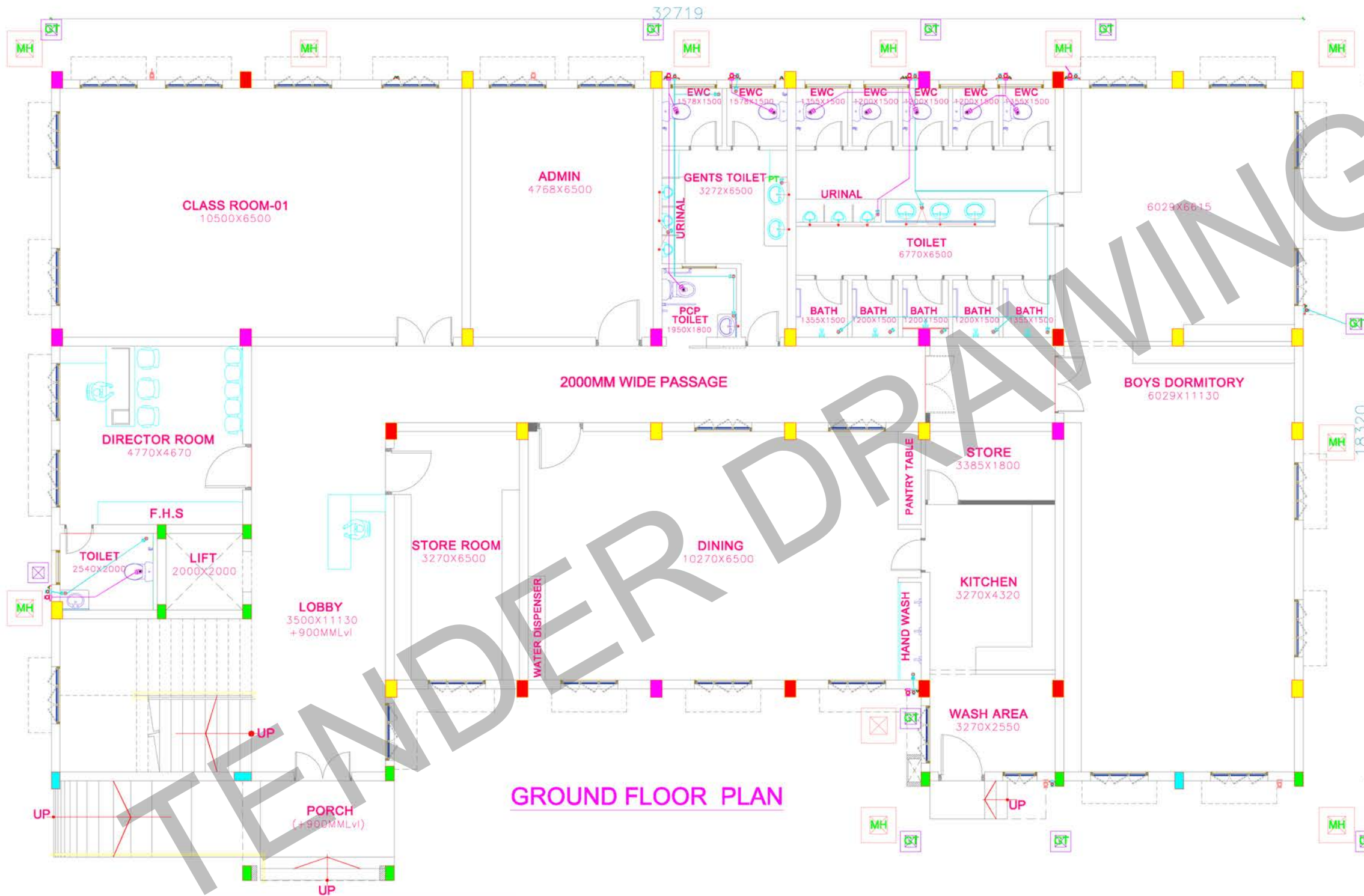

GROUND FLOOR PLAN

PLUMBING LEGENDS

UR	URINAL
WC	INDIAN WATER CLOSET
EWC	EUROPEAN WATER CLOSET
WB	WASH BASIN
SH	SHOWER
CWS	COLD WATER SUPPLY
PS	PLUMBING SHAFT
WP	WASTE PIPE
SP	SOIL PIPE
RWP	RAIN WATER PIPE
PT	P TRAP
GT	GULLY TRAP
MH	MAN HOLE
WWSF	WASTE WATER SOAK PIT
RWHP	RAIN WATER HARVESTING PIT

SPECIFICATION OF PIPES:

—	50Ø PVC PIPE (6KG/SQ.CM)
—	75Ø PVC PIPE (6KG/SQ.CM)
—	110Ø PVC PIPE (6KG/SQ.CM)
—	110Ø PVC PIPE (6KG/SQ.CM)
—	160Ø PVC PIPE (6KG/SQ.CM)

NOTES:

- THIS DRAWING SHALL NOT BE SCALED, ONLY WRITTEN DIMENSIONS TO BE FOLLOWED.
- THIS DRAWING SHALL BE READ IN CONJUNCTION WITH RELEVANT LATEST ARCHITECTURAL AND STRUCTURAL DWG.
- ALL SOIL AND WASTE PIPES SHALL BE PVC PIPES CONFORMING TO IS : 4985-2000 OR SWR 135B2
- ALL FITTINGS LIKE BENDS, TEES ETC. IN DUCT FOR SOIL AND WASTE PIPE SHALL BE PROVIDED WITH DOORS.

PIPE TECHNICAL SPEC

50Ø PVC PIPE (6KG/SQCM)
75Ø PVC PIPE (6KG/SQCM)
110Ø PVC PIPE (6KG/SQCM)
160Ø PVC PIPE (6KG/SQCM)

	300 X 300MM GULLY TRAP
	450 X 450MM MANHOLE
	900MM RAIN WATER HARVESTING PIT
	900MM WASTE WATER SOAK PIT



NOTE: ALL DIMENSIONS ARE IN MM

COPYRIGHT:
All rights reserved, this work is copyright and cannot be or copied in any form or by any means (graphic, electronic or reproduced mechanical, including photocopying) without the written permission of nanda & associates. Any licence, express or implied, to use it for any purpose whatsoever is restricted to the terms of the agreement or implied agreement with nanda & associates.

LEGEND :

- 230MM ,115MM THK BRICK WORK
- R.C.C COLUMN

NORTH POINT :

AREA STATEMENT

PLOT AREA - 4012.00 SQ.M

S.NO.	DESCRIPTION	AREA IN (Sq.m)	AREA IN (Sq.ft)
1	GROUND FLOOR	575.00	6189.00
2	FIRST FLOOR	494.00	5317.00
3	SHR	54.00	581.00
TOTAL		1123.00	12087.00

REV.	DESCRIPTION	DATE	BY	DRN.
------	-------------	------	----	------

CLIENT:
INDIAN BANK

PROJECT :
PROPOSED CONSTRUCTION OF INDIAN BANK'S RURAL SELF EMPLOYMENT TRAINING INSTITUTE AT KRISHNAGIRI, TAMILNADU.

DRAWING TITLE :
SCHEMATIC DRAWING

<input checked="" type="checkbox"/> SCHEMATIC DRAWING	<input type="checkbox"/> WORKING DRAWING
<input type="checkbox"/> TENDER DRAWING	<input type="checkbox"/> AS BUILT DRAWING

SCALE : N.T.S	DATE : 30/01/2026	REV NO: 00
DRAWN BY : ABIRAMI	CHECKED BY : M.S	
JOB NO : 3045/25	DWG NO : ARC - SCH - 02	

ARCHITECT :

NANDA & ASSOCIATES ARCHITECTS

NO.36, SARASWATHI ILLAM, JANAKIRAM COLONY MAIN RD JANAKIRAM COLONY., ARUMBAKKAM., CHENNAI - 600 106
TELEPHONE: 044 2827420 E-mail: nandaassociates@gmail.com

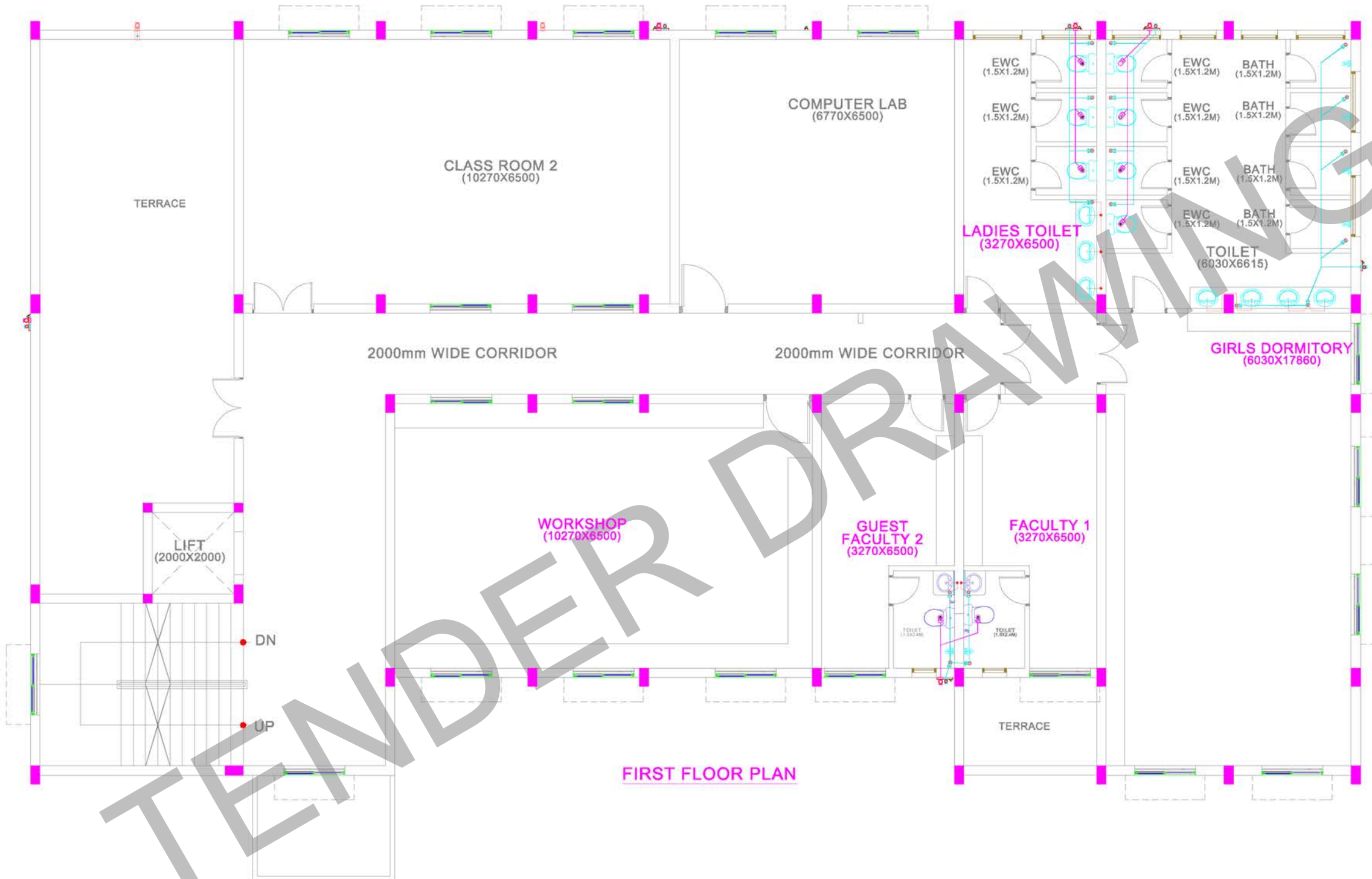

FIRST FLOOR PLAN

PLUMBING LEGENDS

UR	=	URINAL
IWC	=	INDIAN WATER CLOSET
EWC	=	EUROPEAN WATER CLOSET
WB	=	WASH BASIN
SH	=	SHOWER
CWS	=	COLD WATER SUPPLY
PS	=	PLUMBING SHAFT
WP	=	WASTE PIPE
SP	=	SOIL PIPE
RWP	=	RAIN WATER PIPE
PT	=	P TRAP
GT	=	GULLY TRAP
MH	=	MAN HOLE
WWSP	=	WASTE WATER SOAK PIT
RWHP	=	RAIN WATER HARVESTING PIT

SPECIFICATION OF PIPES:

	=	50Ø PVC PIPE (6KG/SQ.CM)
	=	75Ø PVC PIPE (6KG/SQ.CM)
	=	110Ø PVC PIPE (6KG/SQ.CM)
	=	110Ø PVC PIPE (6KG/SQ.CM)
	=	160Ø PVC PIPE (6KG/SQ.CM)

- NOTES:-**
1. THIS DRAWING SHALL NOT BE SCALED. ONLY WRITTEN DIMENSIONS TO BE FOLLOWED.
 2. THIS DRAWING SHALL BE READ IN CONJUNCTION WITH RELEVANT LATEST ARCHITECTURAL AND STRUCTURAL DWG.
 3. ALL SOIL AND WASTE PIPES SHALL BE PVC PIPES CONFORMING TO IS : 4985-2000 OR SWR 13592.
 4. ALL FITTINGS LIKE BENDS, TEES ETC. IN DUCT FOR SOIL AND WASTE PIPE SHALL BE PROVIDED WITH DOORS.

PIPE TECHNICAL SPEC

50Ø PVC PIPE (6KG/SQCM)
75Ø PVC PIPE (6KG/SQCM)
110Ø PVC PIPE (6KG/SQCM)
160Ø PVC PIPE (6KG/SQCM)

	=	300 X 300MM GULLY TRAP
	=	450 X 450MM MANHOLE
	=	900MM RAIN WATER HARVESTING PIT
	=	900MM WASTE WATER SOAK PIT



- NOTES:-**
1. ROOF HEIGHT 3300 ROOF TOP TO TOP
 2. LINTEL HEIGHT 2100 .
 3. SILL HEIGHT 750 .
 4. WINDOW HEIGHT 1350 .

COPYRIGHT:
All rights reserved. This work is copyright and cannot be or copied in any form or by any means (graphic, electronic or reproduced mechanical, including photocopying) without the written permission of nanda & associates. Any licence, express or implied, to use the document for any purpose whatsoever is restricted to the terms of the agreement or implied agreement with nanda & associates

LEGEND:-

	230MM , 115MM THK BRICK WORK
	R.C.C COLUMN

NORTH POINT :

AREA STATEMENT

PLOT AREA AS PER FMB - 4012.00 SQ.M

S.NO.	DESCRIPTION	AREA IN SQ.M	AREA IN SQ.FT
1	GROUND FLOOR	575.00	6,190.00
2	FIRST FLOOR	494.00	5,317.00
3	SHR	54.00	581.00
	TOTAL AREA	1,123.00	12,088.00

CLIENT:
INDIAN BANK

PROJECT :
PROPOSED CONSTRUCTION OF INDIAN BANK'S RURAL SELF EMPLOYMENT TRAINING INSTITUTE AT KRISHNAGIRI, TAMILNADU.

DRAWING TITLE :
FIRST FLOOR DRAINAGE LAYOUT

SCHEMATIC DRAWING WORKING DRAWING
 TENDER DRAWING AS BUILT DRAWING

SCALE : N.T.S	DATE : 28/02/2025	REV NC
DRAWN BY : SHAM	CHECKED BY : Muni	01
JOB NO : 3045/25	DWG NO : ARC - SCH - 01	

ARCHITECT :-

NANDA & ASSOCIATES ARCHITECTS

NO.36, SARASWATHI ILLAM, JANAKIRAM COLONY MAIN RD, JANAKIRAM COLONY., ARUMBAKKAM., CHENNAI - 600 106.
TELEPHONE: 044 23627425 E-mail: nandaarchitects@gmail.com

COPYRIGHT:
All rights reserved. This work is copyright and cannot be or copied in any form or by any means (graphic, electronic or reproduced mechanical, including photocopying) without the written permission of nanda & associates. Any licence, express or implied, to use the document for any purpose whatsoever is restricted to the terms of the agreement or implied agreement with nanda & associates

LEGEND:-

230MM, 115MM THK BRICK WORK

R.C.C COLUMN

NORTH POINT :

AREA STATEMENT

PLOT AREA AS PER FMB - 4012.00 SQ.M

S.NO.	DESCRIPTION	AREA IN SQ.M	AREA IN SQ.FT
1	GROUND FLOOR	575.00	6,190.00
2	FIRST FLOOR	494.00	5,317.00
3	SHR	54.00	581.00
TOTAL AREA		1,123.00	12,088.00

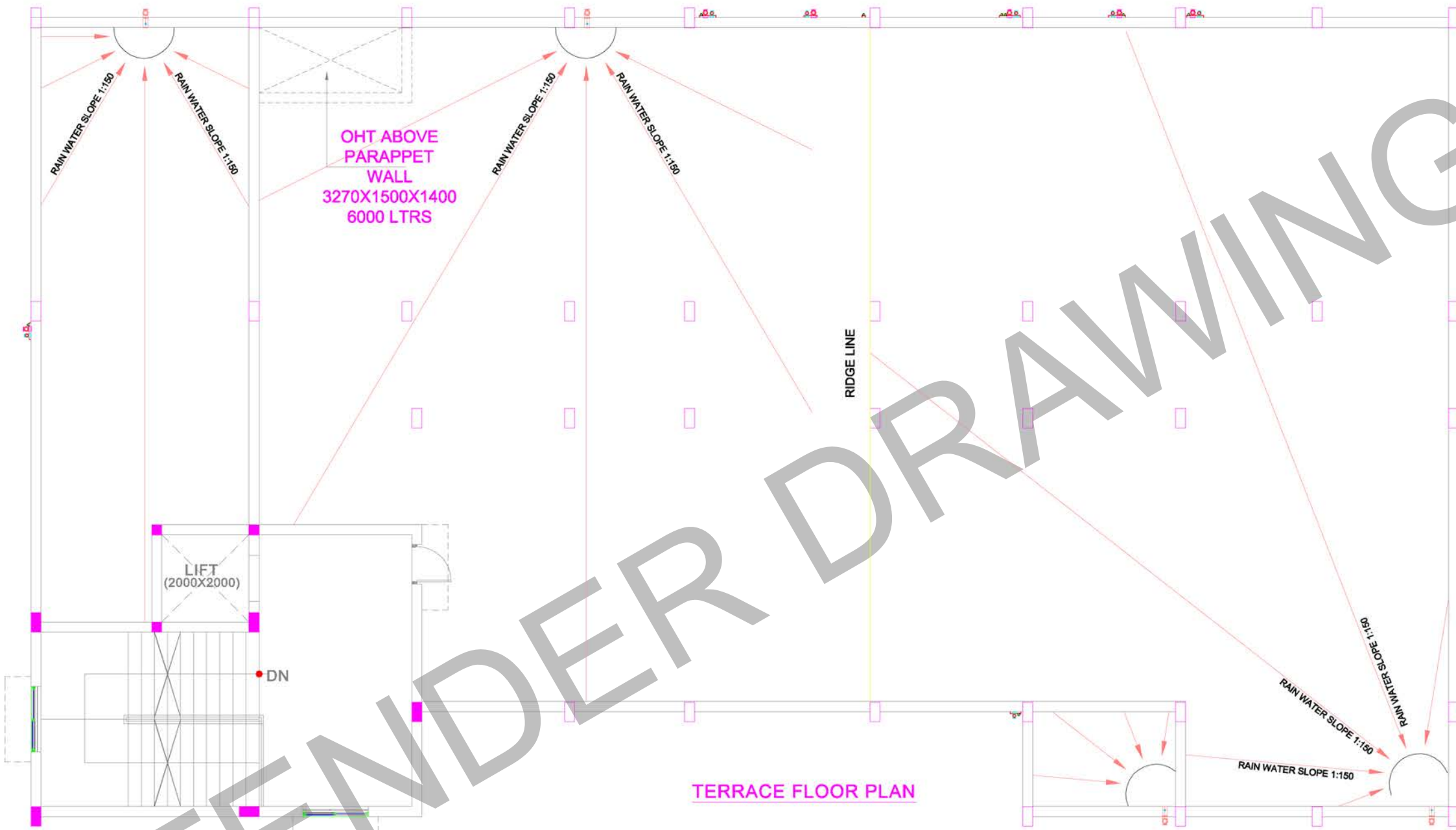

TERRACE FLOOR PLAN

PLUMBING LEGENDS

- UR - URINAL
- WC - INDIAN WATER CLOSET
- EW - EUROPEAN WATER CLOSET
- WB - WASH BASIN
- SH - SHOWER
- CWS - COLD WATER SUPPLY
- PS - PLUMBING SHAFT
- WP - WASTE PIPE
- SP - SOIL PIPE
- RWP - RAIN WATER PIPE
- PT - P TRAP
- GT - GULLY TRAP
- MH - MAN HOLE
- WWSP - WASTE WATER SOAK PIT
- RWHP - RAIN WATER HARVESTING PIT

SPECIFICATION OF PIPES:

- 50# PVC PIPE (6KG/SQ.CM)
- 75# PVC PIPE (6KG/SQ.CM)
- 110# PVC PIPE (6KG/SQ.CM)
- 160# PVC PIPE (6KG/SQ.CM)

NOTES:-

- THIS DRAWING SHALL NOT BE SCALED. ONLY WRITTEN DIMENSIONS TO BE FOLLOWED.
- THIS DRAWING SHALL BE READ IN CONJUNCTION WITH RELEVANT LATEST ARCHITECTURAL AND STRUCTURAL DWG
- ALL SOIL AND WASTE PIPES SHALL BE PVC PIPES CONFORMING TO IS - 4985-2000 OR SWR 13592
- ALL FITTINGS LIKE BENDS, TEES ETC. IN DUCT FOR SOIL AND WASTE PIPE SHALL BE PROVIDED WITH DGCRS.

PIPE TECHNICAL SPEC

- 50# PVC PIPE (6KG/SQCM)
- 75# PVC PIPE (6KG/SQCM)
- 110# PVC PIPE (6KG/SQCM)
- 160# PVC PIPE (6KG/SQCM)

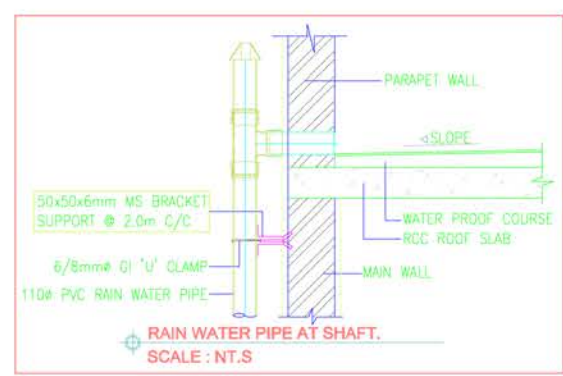
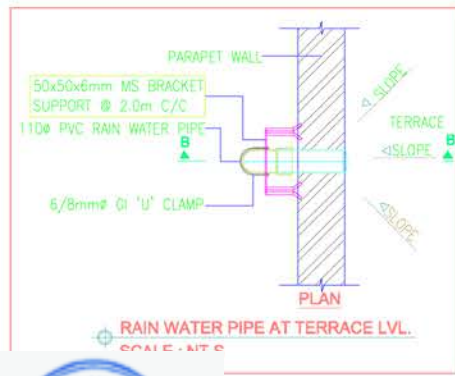

NOTES:-

- ROOF HEIGHT 3300 ROOF TOP TO TOP
- LINTEL HEIGHT 2100 .
- SILL HEIGHT 750 .
- WINDOW HEIGHT 1350 .



CLIENT:
INDIAN BANK

PROJECT :
PROPOSED CONSTRUCTION OF INDIAN BANK'S RURAL SELF EMPLOYMENT TRAINING INSTITUTE AT KRISHNAGIRI, TAMILNADU.

DRAWING TITLE :
TERRACE FLOOR RAIN WATER DRAIN LAYOUT

SCHEMATIC DRAWING WORKING DRAWING
 TENDER DRAWING AS BUILT DRAWING

SCALE : N.T.S DATE : 28/02/2025 REV NC : 01
DRAWN BY : SHAM CHECKED BY : Muni
JOB NO : 3045/25 DWG NO : ARC - SCH - 01

ARCHITECT :-
NANDA & ASSOCIATES ARCHITECTS
NO.36, SARASWATHI ILLAM, JANAKIRAM COLONY MAIN RD, JANAKIRAM COLONY., ARUMBAKKAM., CHENNAI - 600 106.
TELEPHONE: 044 23627205

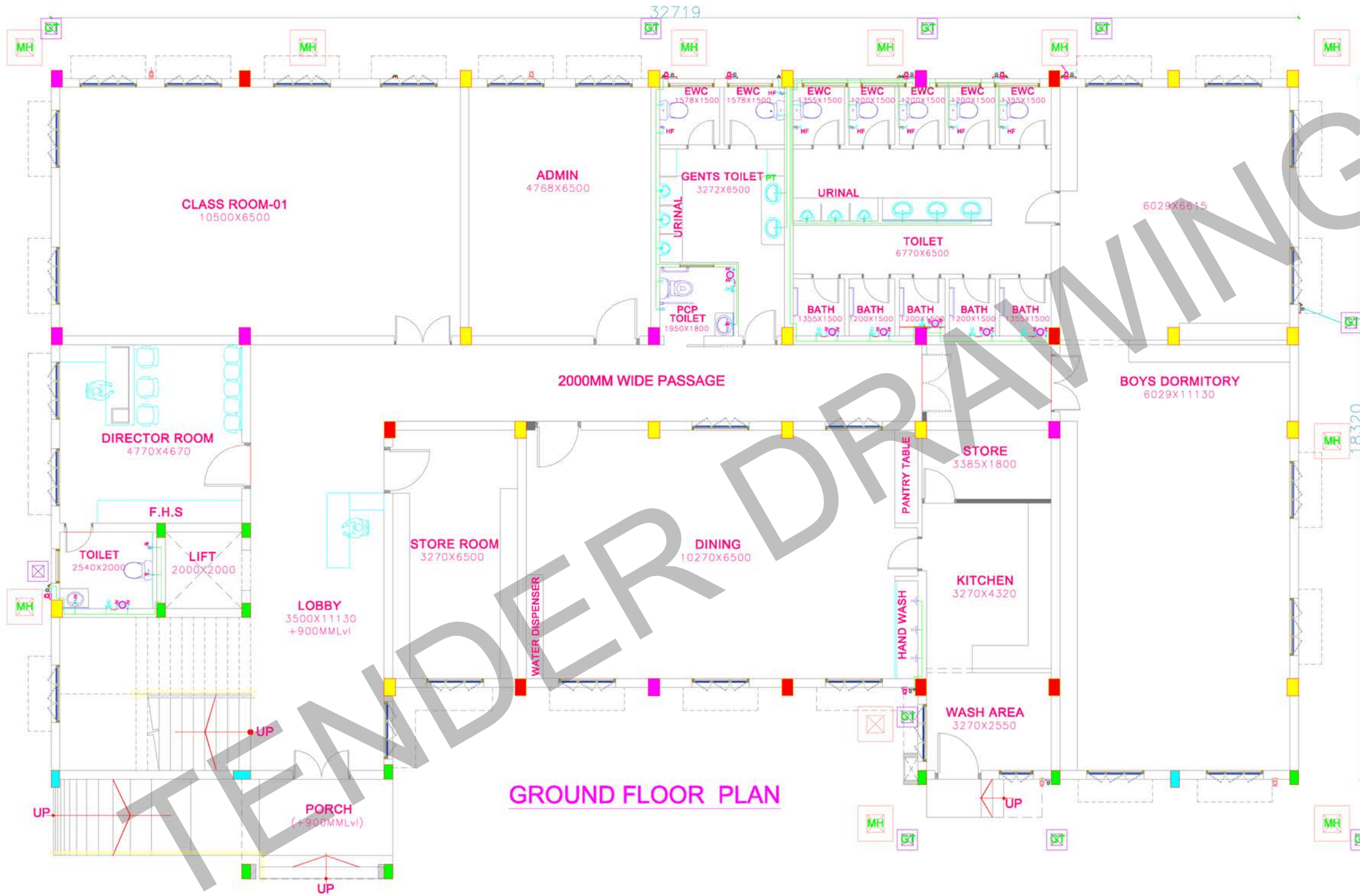

GROUND FLOOR PLAN

COPYRIGHT:
All rights reserved. this work is copyright and cannot be copied in any form or by any means (graphic, electronic or reproduced mechanical, including photocopying) without the written permission of nanda & associates. Any licence, express or implied, to use this document for any purpose whatsoever is restricted to the terms of the agreement or implied agreement with nanda & associates.

LEGEND :

- 230MM, 115MM THK BRICK WORK
- R.C.C COLUMN

NORTH POINT :

AREA STATEMENT

PLOT AREA - 4012.00 SQ.M

S.NO.	DESCRIPTION	AREA IN (Sq.m)	AREA IN (Sq.ft)
1	GROUND FLOOR	575.00	6189.00
2	FIRST FLOOR	494.00	5317.00
3	SHR	54.00	581.00
TOTAL		1123.00	12087.00

REV.	DESCRIPTION	DATE	BY	DRN.

CLIENT:
INDIAN BANK

PROJECT :
PROPOSED CONSTRUCTION OF INDIAN BANK'S RURAL SELF EMPLOYMENT TRAINING INSTITUTE AT KRISHNAGIRI, TAMILNADU.

DRAWING TITLE :
GROUND FLOOR WATER SUPPLY LAYOUT

- SCHEMATIC DRAWING
- WORKING DRAWING
- TENDER DRAWING
- AS BUILT DRAWING

SCALE : N.T.S **DATE :** 30/01/2026 **REV NO:** 00
DRAWN BY : ABIRAMI **CHECKED BY :** M.S
JOB NO : 3045/25 **DWG NO :** ARC - SCH - 02

ARCHITECT :

NANDA & ASSOCIATES ARCHITECTS

NO.36, SARASWATHI ILLAM, JANAKIRAM COLONY MAIN RD
 JANAKIRAM COLONY, ARUMBAKKAM., CHENNAI - 600 106
 TEL:PHONE:044-23274205 E-mail:nandaassociates@gmail.com

LEGEND

- WB = WASH BASIN
- HF = HEALTH FAUCET
- AV = ANGLE VALVE
- PS = PLUMBING SHAFT
- CWS = COLD WATER SUPPLY
- EWC = EUROPEAN WATER CLOSET
- BV = BALL VALVE
- UR = URINAL
- PC = PUSH COCK
- G = GEYSER
- SH = SHOWER
- LBC = LONG BODY BIBCOCK
- IWC = INDIAN WATER CLOSET

MOUNTING HEIGHT

S/NO	SCHEDULE OF FIXTURE / FITTINGS	MOUNTING HTS FROM F.F.L
01	EUROPEAN WATER CLOSET	1'-4"
02	WASH BASIN	2'-8"
03	AV FOR WASH BASIN	1'-8"
04	TAP / HEALTH FAUCET FOR ERC	1'-0"
05	OPEN FLUSH TANK INLET	5'-0"
06	PUSH COCK FOR URINAL	4'-8"
07	SHOWER ARM WITH ROSE	6'-10"
08	WALL MIXER	5'-0"
09	GEYSER	6'-6"
10	TAP POINT FOR WASH	2'-8"

- MAKES CONSIDERED:**
- PUMPS:**
 - * SUBMERSIBLE PUMPS FOR BORE WELL WATER TRANSFER TO DHT.
 - * SUBMERSIBLE PUMPS FOR SUMP WATER TRANSFER TO DHT.
 - WATER SUPPLY PIPES:**
 - * FLOW GUARD CPVC SDR-11 FOR INTERNAL HWS & CWS
 - * UPVC SCH-40 PIPES & SCH-80 FITTINGS FOR EXTERNAL PIPING
 - WATER CLOSET:**
 - * FLOOR MOUNTED EUROPEAN WATER CLOSET WITH SEAT COVER WITH DUAL FLUSHING SYSTEM.
 - OP FITTINGS:**
 - * PULLER COCK, HSB COCK, HEALTH FAUCET WITH ANGLE STOP COCK, SHOWER AND WASTE COUPLING
 - WASH BASIN AREA:**
 - * WALL MOUNTED WASH BASIN WITH SUPPORTING BRACKETS AND WASTE COUPLING
 - OP FITTINGS MAKE:** CLIENT SCOPE
 - SANITARY WARE MAKE:** CLIENT SCOPE

WATER SUPPLY PIPES SPECIFICATION

FLOW GUARD CPVC SDR-11 FOR INTERNAL HWS & CWS
 UPVC SCH-40 PIPES & SCH-80 FITTINGS FOR EXTERNAL PIPING

WATER SUPPLY CIVIL NOTES:

- COLD WATER WILL BE USED FOR FLOWING, WASH BASIN, SHOWER, HEALTH FAUCETS & KITCHEN ETC.
- VERTICAL HEADER PROVIDE CONTROL VALVE AT STORAGE LEVEL.
- ALL WATER SUPPLY PIPES ARE TO BE PRESSURE TESTED TO 7kg/Sq.Cm TO A MINIMUM OF 2 HOURS.
- BEFORE PROCEEDING WITH INTERNAL SOIL, WASTE & WATER SUPPLY WORK, CONTRACTOR TO VERIFY THE INLET & OUTLET OF THE SELECTED SANITARY WARES & C.P.FITTINGS NO WORK ARE TO BE CARRIED OUT WITHOUT HAVING THE SAMPLE OF ALL THE TYPE OF THE SAME AT SITE



NOTE: ALL DIMENSIONS ARE IN MM

COPYRIGHT:
All rights reserved. This work is copyright and cannot be or copied in any form or by any means (graphic, electronic or reproduced mechanical, including photocopying) without the written permission of nanda & associates. Any license, express or implied, to use the document for any purpose whatsoever is restricted to the terms of the agreement or implied agreement with nanda & associates

LEGEND:-

230MM, 115MM THK BRICK WORK

R.C.C COLUMN

NORTH POINT :

AREA STATEMENT

PLOT AREA AS PER FMB - 4012.00 SQ.M

S.NO.	DESCRIPTION	AREA IN SQ.M	AREA IN SQ.FT
1	GROUND FLOOR	575.00	6,190.00
2	FIRST FLOOR	494.00	5,317.00
3	SHR	54.00	581.00
	TOTAL AREA	1,123.00	12,088.00

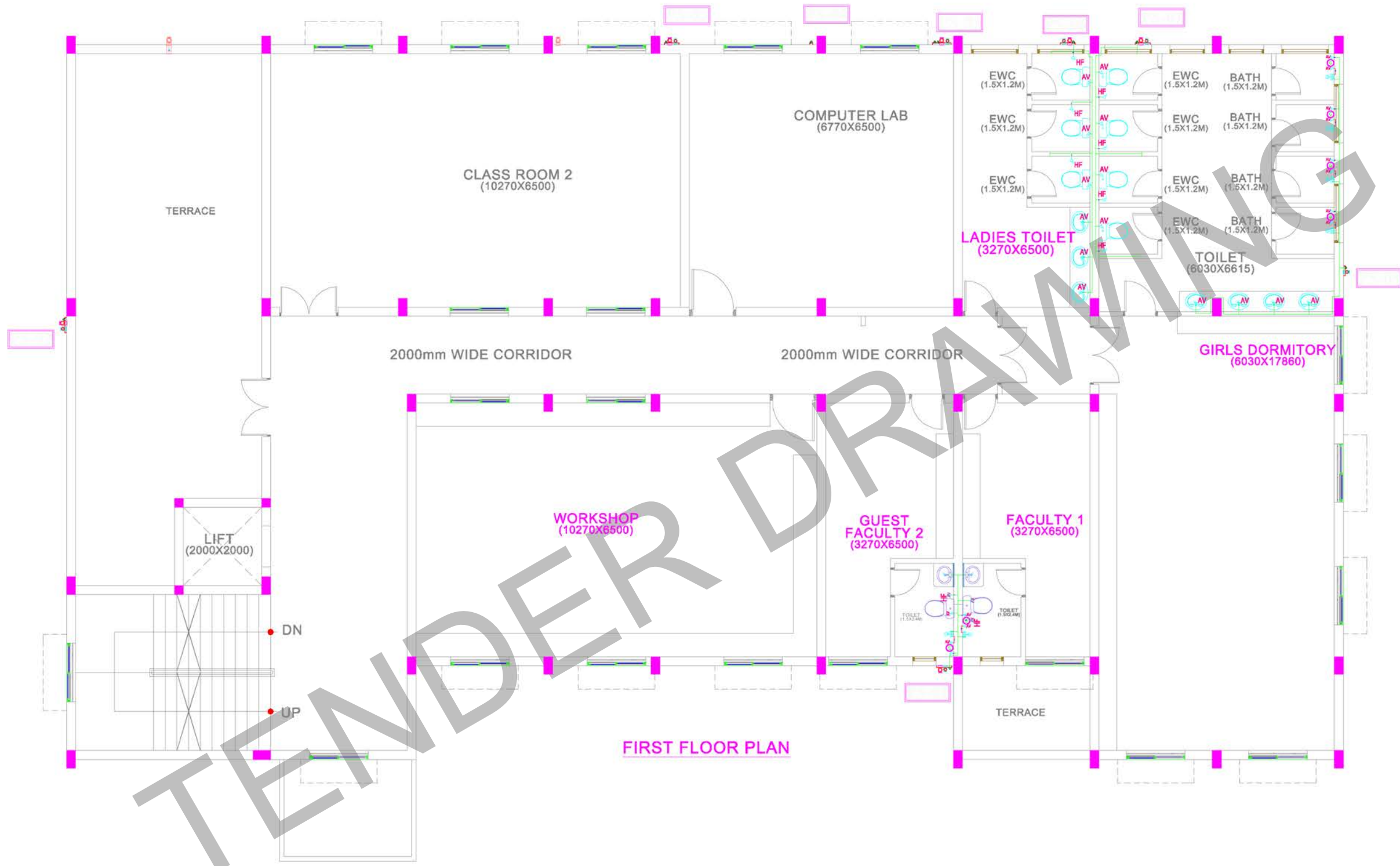

FIRST FLOOR PLAN

CLIENT:
INDIAN BANK

PROJECT :
PROPOSED CONSTRUCTION OF INDIAN BANK'S RURAL SELF EMPLOYMENT TRAINING INSTITUTE AT KRISHNAGIRI, TAMILNADU.

DRAWING TITLE :
FIRST FLOOR WATER SUPPLY LAYOUT

SCHEMATIC DRAWING WORKING DRAWING

TENDER DRAWING AS BUILT DRAWING

SCALE : N.T.S **DATE :** 28/02/2025 **REV NC** 01

DRAWN BY : SHAM **CHECKED BY :** Muni

JOB NO : 3045/25 **DWG NO :** ARC - SCH - 01

ARCHITECT :
NANDA & ASSOCIATES ARCHITECTS
NO.36, SARASWATHI ILLAM, JANAKIRAM COLONY MAIN RD. JANAKIRAM COLONY., ARUMBAKKAM., CHENNAI - 600 106. TELEPHONE: 044 28274200. E-mail: nandaarchitects@gmail.com

LEGEND

WB	=	WASH BASIN
HF	=	HEALTH FAUCET
AV	=	ANGLE VALVE
PS	=	PLUMBING SHAFT
CWS	=	COLD WATER SUPPLY
EWC	=	EUROPEAN WATER CLOSET
BV	=	BALL VALVE
UR	=	URINAL
PC	=	PUSH COCK
G	=	GEYSER
SH	=	SHOWER
LBC	=	LONG BODY BIBCOCK
IWC	=	INDIAN WATER CLOSET

MOUNTING HEIGHT

SL. NO	SCHEDULE OF FIXTURE / FITTINGS	MOUNTING HTS FROM F.F.L.
01	EUROPEAN WATER CLOSET	1'-4"
02	WASH BASIN	2'-6"
03	AV FOR WASH BASIN	1'-6"
04	TAP / HEALTH FAUCET FOR EWC	1'-0"
05	OPEN FLUSH TANK INLET	3'-0"
06	PUSH COCK FOR URINAL	4'-6"
07	SHOWER ARM WITH ROSE	6'-10"
08	WALL MIXER	3'-0"
09	GEYSER	6'-6"
10	TAP POINT FOR WASH	2'-6"

MAKES CONSIDERED:

PUMPS: * SUBMERSIBLE PUMPS FOR BORE WELL WATER TRANSFER TO OHT.
* SUBMERSIBLE PUMPS FOR SUMP WATER TRANSFER TO OHT.

WATER SUPPLY PIPES: FLOW GUARD CPVC SDR-11 FOR INTERNAL HWS & CWS
UPVC SCH-40 PIPES & SCH-80 FITTINGS FOR EXTERNAL PIPING

WATER CLOSET: FLOOR MOUNTED EUROPEAN WATER CLOSET WITH SEAT COVER WITH DUAL FLUSHING SYSTEM.

CP FITTINGS: PILLAR COCK, BIB COCK, HEALTH FAUCET WITH ANGLE STOP COCK, SHOWER AND WASTE COUPLING

WASH BASIN AREA: WALL MOUNTED WASH BASIN WITH SUPPORTING BRACKETS AND WASTE COUPLING

CP FITTINGS MAKE: CLIENT SCOPE

SANITARY WARE MAKE: CLIENT SCOPE

WATER SUPPLY PIPES SPECIFICATION

FLOW GUARD CPVC SDR-11 FOR INTERNAL HWS & CWS
UPVC SCH-40 PIPES & SCH-80 FITTINGS FOR EXTERNAL PIPING

WATER SUPPLY PIPE NOTES:

- COLD WATER WILL BE USED FOR FLUSHING, WASH BASIN, SHOWER, HEALTH FAUCETS & KITCHEN ETC.
- VERTICAL HEADER PROVIDE CONTROL VALVE AT TERRACE LEVEL.
- ALL WATER SUPPLY PIPES ARE TO BE PRESSURE TESTED TO 7kg/30cm TO A MINIMUM OF 2 HOURS.
- BEFORE PROCEEDING WITH INTERNAL SOIL, WASTE & WATER SUPPLY WORK, CONTRACTOR TO VERIFY THE INLET & OUTLET OF THE SELECTED SANITARY WARES & C/P FITTINGS. NO WORK ARE TO BE CARRIED OUT WITHOUT HAVING THE SAMPLE OF ALL THE TYPE OF THE SAME AT SITE.

NOTES:-

1. ROOF HEIGHT 3300 ROOF TOP TO TOP
2. LINTEL HEIGHT 2100 .
3. SILL HEIGHT 750 .
4. WINDOW HEIGHT 1350 .



COPYRIGHT:
All rights reserved. This work is copyright and cannot be or copied in any form or by any means (graphic, electronic or reproduced mechanical, including photocopying) without the written permission of nanda & associates. Any licence, express or implied, to use the document for any purpose whatsoever is restricted to the terms of the agreement or implied agreement with nanda & associates.

LEGEND:-

 230MM, 115MM THK BRICK WORK
 R.C.C COLUMN
NORTH POINT :

AREA STATEMENT

PLOT AREA AS PER FMB - 4012.00 SQ.M

S.NO.	DESCRIPTION	AREA IN SQ.M	AREA IN SQ.FT
1	GROUND FLOOR	575.00	6,190.00
2	FIRST FLOOR	494.00	5,317.00
3	SHR	54.00	581.00
	TOTAL AREA	1,123.00	12,088.00

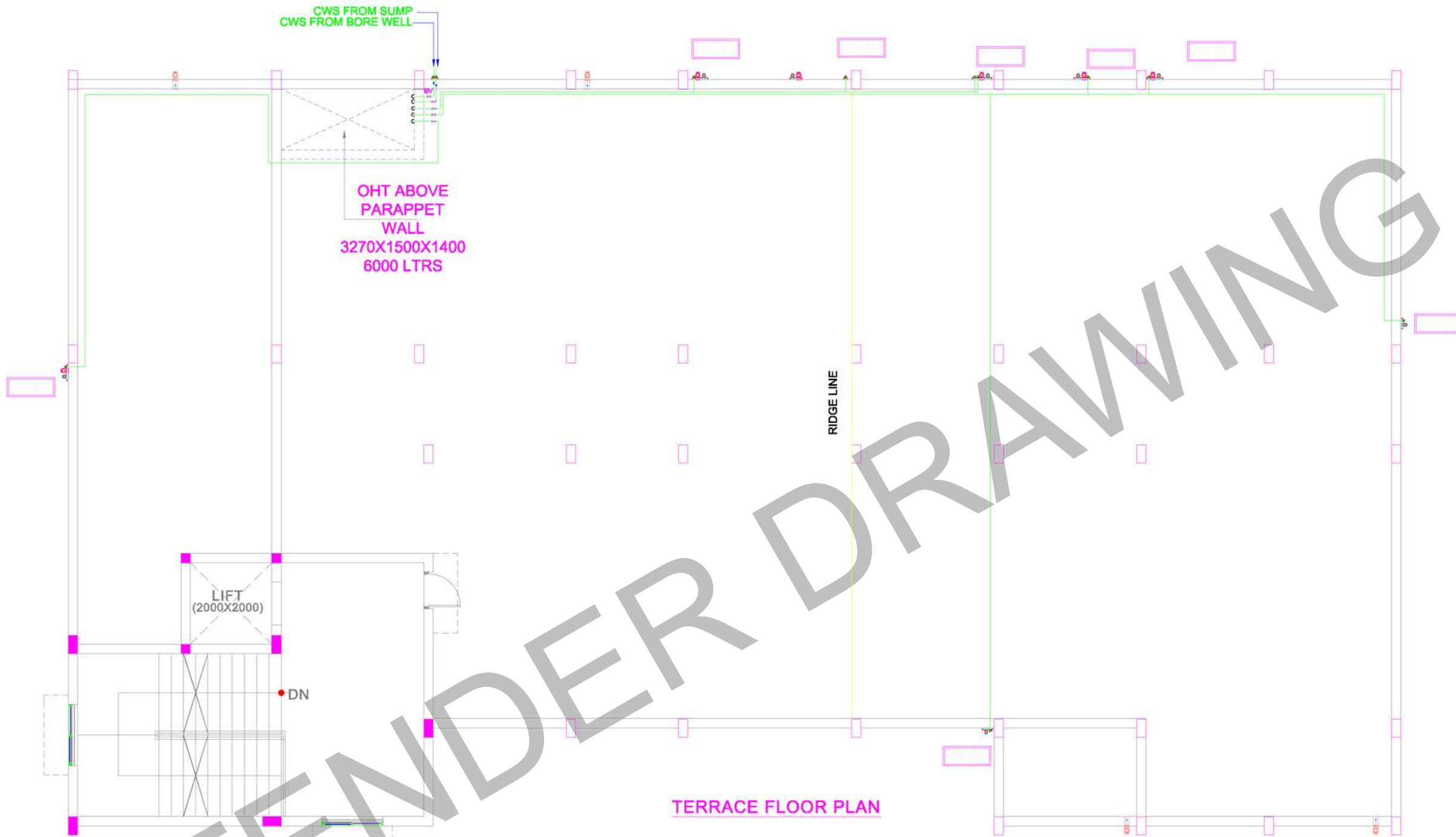

TERRACE FLOOR PLAN

PLUMBING LEGENDS

UR	- URINAL
IWC	- INDIAN WATER CLOSET
EWC	- EUROPEAN WATER CLOSET
WB	- WASH BASIN
SH	- SHOWER
CWS	- COLD WATER SUPPLY
PS	- PLUMBING SHAFT
WP	- WASTE PIPE
SP	- SOIL PIPE
RWP	- RAIN WATER PIPE
PT	- P TRAP
GT	- GULLY TRAP
MH	- MAN HOLE
WWSP	- WASTE WATER SOAK PIT
RWHP	- RAIN WATER HARVESTING PIT

SPECIFICATION OF PIPES:

	- 50ø PVC PIPE (6KG/SQ.CM)
	- 75ø PVC PIPE (6KG/SQ.CM)
	- 110ø PVC PIPE (6KG/SQ.CM)
	- 110ø PVC PIPE (6KG/SQ.CM)
	- 160ø PVC PIPE (6KG/SQ.CM)

NOTES:-

1. THIS DRAWING SHALL NOT BE SCALED. ONLY WRITTEN DIMENSIONS TO BE FOLLOWED.
2. THIS DRAWING SHALL BE READ IN CONJUNCTION WITH RELEVANT LATEST ARCHITECTURAL AND STRUCTURAL DWG.
3. ALL SOIL AND WASTE PIPES SHALL BE PVC PIPES CONFORMING TO IS : 4985-2000 OR SWR 13592
4. ALL FITTINGS LIKE BENDS, TEES ETC. IN DUCT FOR SOIL AND WASTE PIPE SHALL BE PROVIDED WITH DOORS.

PIPE TECHNICAL SPEC

50ø PVC PIPE (6KG/SQCM)
75ø PVC PIPE (6KG/SQCM)
110ø PVC PIPE (6KG/SQCM)
160ø PVC PIPE (6KG/SQCM)

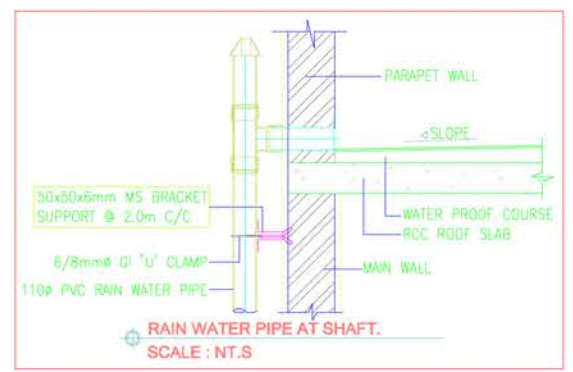
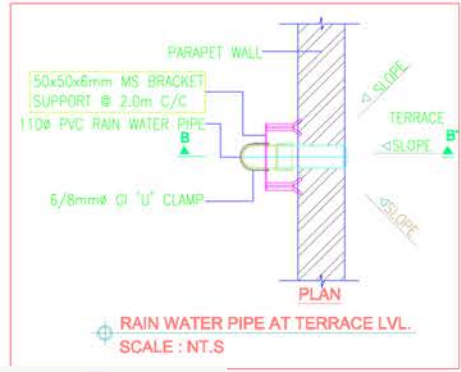

- NOTES:-**
1. ROOF HEIGHT 3300 ROOF TOP TO TOP
 2. LINTEL HEIGHT 2100 .
 3. SILL HEIGHT 750 .
 4. WINDOW HEIGHT 1350 .



CLIENT:
INDIAN BANK

PROJECT :
PROPOSED CONSTRUCTION OF INDIAN BANK'S RURAL SELF EMPLOYMENT TRAINING INSTITUTE AT KRISHNAGIRI, TAMILNADU.

DRAWING TITLE :
TERRACE FLOOR WATER SUPPLY LAYOUT

SCHEMATIC DRAWING WORKING DRAWING
 TENDER DRAWING AS BUILT DRAWING

SCALE : N.T.S	DATE : 28/02/2025	REV NC
DRAWN BY : SHAM	CHECKED BY : Muni	01
JOB NO : 3045/25	DWG NO : ARC - SCH - 01	

ARCHITECT :
 **NANDA & ASSOCIATES**
 ARCHITECTS
 NO.36, SARASWATHI ILLAM, JANAKIRAM COLONY MAIN RD.
 JANAKIRAM COLONY., ARUMBAKKAM., CHENNAI - 600 106.
 TEL: 044-23274305

WATER SUPPLY PIPES SPECIFICATION

FLOW GUARD CPVC SDR-11 FOR INTERNAL HWS & CWS
UPVC SCH-40 PIPES & SCH-80 FITTINGS FOR EXTERNAL PIPING

WATER SUPPLY PIPE WORK

- 1- COLD WATER WILL BE USED FOR FLUSHING, WASH BASIN, SHOWER, HEALTH FACETS & KITCHEN ETC.
- 2- VERTICAL HEADER PROVIDE STOPVALVE AT TERRACE LEVEL.
- 3- ALL WATER SUPPLY PIPES ARE TO BE PRESSURE TESTED TO 3kg/200cm TO A MINIMUM OF 3 HOURS.
- 4- BEFORE PROCEEDING WITH INTERNAL SANITARY & WATER SUPPLY WORK, CONTRACTOR TO VERIFY THE INLET & OUTLET OF THE SELECTED SANITARY WARES & C/P FITTINGS. NO WORK ARE TO BE CARRIED OUT WITHOUT TAKING THE SAMPLE OF ALL THE TYPE OF THE WARE AT SITE.

SL. NO.	DESCRIPTION OF FEATURE / FITTING	QUANTITY REQ. FROM P.F.L.
01	EUROPEAN WATER CLOSET	11-4
02	WASH BASIN	7-8
03	AV FOR WASH BASIN	7-8
04	TAP / HEALTH FAUCET FOR EWC	11-0
05	WASH FLUSH TANK HEAT	3-0
06	FRESH COOK FOR URINAL	4-0
07	SHOWER BATH WITH ROSE	1-0
08	WELL HEAD	1-0
09	COCKER	0-0
10	TAP ROSE FOR WASH	7-8

MAKES CONSIDERED:

- PLUMBING:
 - 1- ENFORCEMENT STAMP FOR BORE WELL WITH APPROVAL AT SITE.
 - 2- ENFORCEMENT STAMP FOR COLD WATER TANK WITH APPROVAL AT SITE.
- WATER SUPPLY PIPES:
 - 1- FLOW GUARD CPVC SDR-11 FOR INTERNAL HWS & CWS.
 - 2- UPVC SCH-40 PIPES & SCH-80 FITTINGS FOR EXTERNAL PIPING.
- WATER TANK:
 - 1- FLOW GUARDED LIGHTER WATER TANK WITH HEAT COVER WITH VENTILATION.
- CP FITTINGS:
 - 1- FULLY COOK FOR WASH BASIN & WASH FLUSH TANK.
 - 2- FULLY COOK FOR SHOWER BATH.
- WASH FLUSH AREA:
 - 1- FULLY COOKED WASH FLUSH TANK WITH SUPPORTING BRACKETS AND CP FITTINGS.
- CP FITTINGS:
 - 1- FULLY COOKED WASH FLUSH TANK WITH SUPPORTING BRACKETS AND CP FITTINGS.
- SHOWER BATH:
 - 1- FULLY COOKED WASH FLUSH TANK WITH SUPPORTING BRACKETS AND CP FITTINGS.
- WELL HEAD:
 - 1- FULLY COOKED WASH FLUSH TANK WITH SUPPORTING BRACKETS AND CP FITTINGS.

LEGEND

- W = WASH BASIN
- WV = WASH VALVE
- AV = ANGLE VALVE
- PS = PLUMBING SHAFT
- CWS = COLD WATER SUPPLY
- EWC = EUROPEAN WATER CLOSET
- BV = BALL VALVE
- UR = URINAL
- PC = PUSH COCK
- G = GEYSER
- SH = SHOWER
- LBC = LONG BODY BIDCOCK
- IWC = INDIAN WATER CLOSET

LEGEND:-

- 230MM THK BRICK WORK
- R.C.C COLUMN

NORTH POINT :

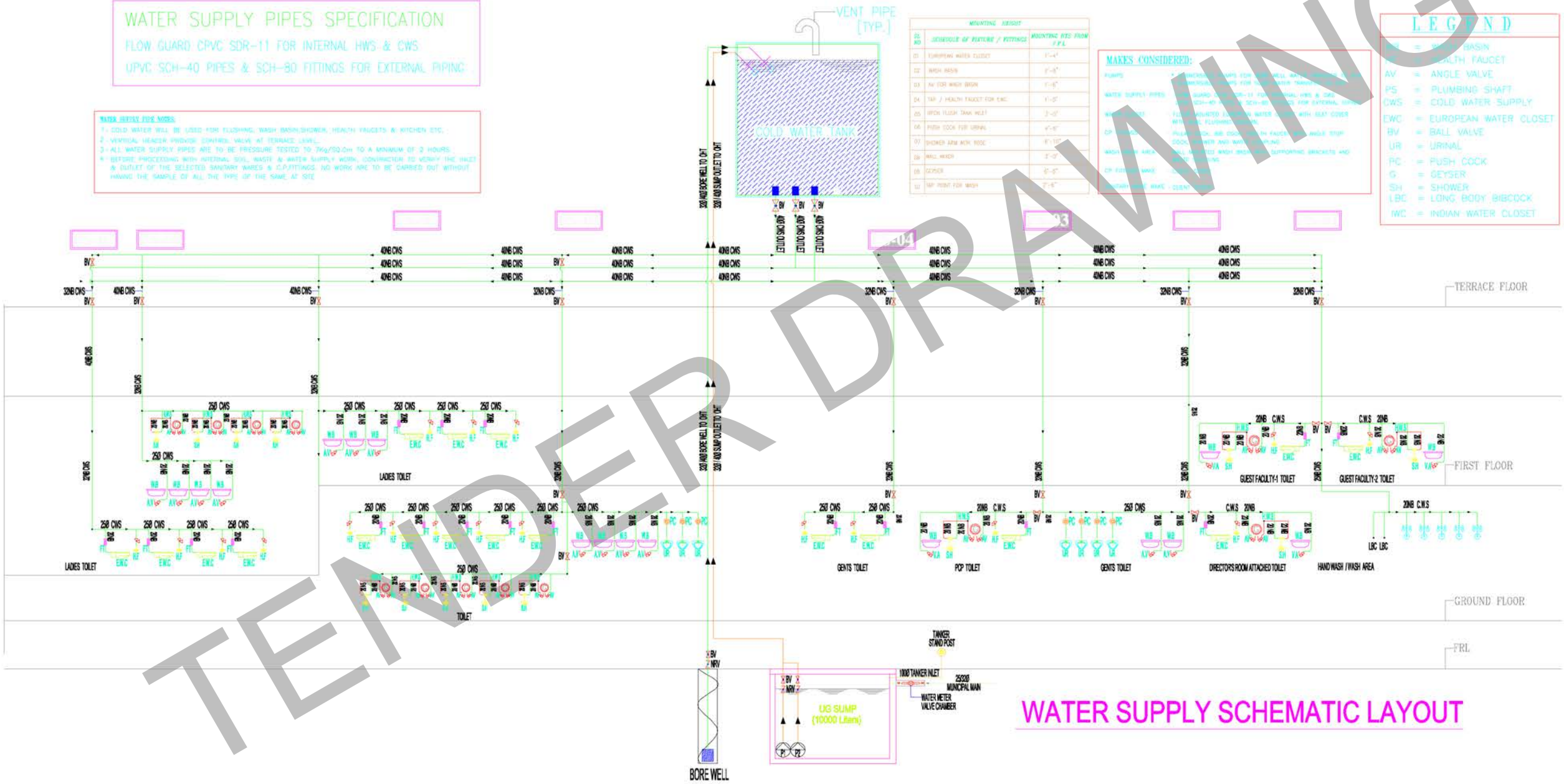

WATER SUPPLY SCHEMATIC LAYOUT

CLIENT:
INDIAN BANK

PROJECT:
PROPOSED CONSTRUCTION OF INDIAN BANK'S RURAL SELF EMPLOYMENT TRAINING INSTITUTE AT KRISHNAGIRI, TAMILNADU.

DRAWING TITLE:
WATER SUPPLY SCHEMATIC LAYOUT

- SCHEMATIC DRAWING
- WORKING DRAWING
- TENDER DRAWING
- AS BUILT DRAWING

SCALE : N.T.S	DATE : 28/02/2025	REV NC
DRAWN BY : SHAM	CHECKED BY : Muni	01
JOB NO : 3045/25	DWG NO : ARC - SCH - 01	

PLUMBING CONSULTANTS:

PRIVALS CONSULTANTS
 Plumbing Fire Fighting Industrial Kitchen
 NO.5/154, 64th STREET,
 SIDCO NAGAR,
 VILLIVAKKAM, CHENNAI-600 049.
 E.MAIL : privals@gmail.com
 Mobile : 98402 68102

ARCHITECT :

N&A NANDA & ASSOCIATES ARCHITECTS
 NO.36, SARASWATHI ILLAM, JANAKIRAM COLONY MAIN RD.
 JANAKIRAM COLONY, ARUMBAKKAM., CHENNAI - 600 106.

