

**NOTE:**

1. THIS DRAWING IS THE PROPERTY OF THE ARCHITECT AND SHALL NOT BE COPIED WITHOUT HIS PERMISSION.
2. DISCREPANCIES FOUND IN THE DRAWING SHALL BE BROUGHT TO THE ARCHITECT'S NOTICE IMMEDIATELY.
3. DRAWINGS SHALL BE READ AND SHOULD NOT BE SCALED.

**PROJECT :**

PROPOSED INTERIOR PLAN FOR  
**INDIAN BANK**  
**KONGAREDDY PALLI**  
**BRANCH (CHITTOOR)**  
**TIRUPATI (R.O)**

PROPOSED INTERIOR PLAN  
**GROUND FLOOR**

**DRG TITLE :**

DESIGNED BY: FA  
 DRAWN BY: NISSI  
 CHECKED BY : FA  
 DATE : 23-12-2025  
 SCALE : NTS

**NORTH :**

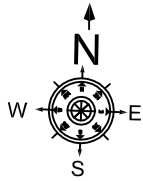

**ARCHITECT:**

**FIROZ AHMED, M.Arch.,**  
 H.NO 13-6-436/A/33,  
 LAKSHMI APARTMENTS,  
 2nd FLOOR, 301, LAKSHMI NAGAR  
 PILLAR NO.68, MEHIDIPATNAM,  
 HYDERABAD-028.  
 CELL: 98481 49737

**OPTION - 05**

SOUTH ROAD

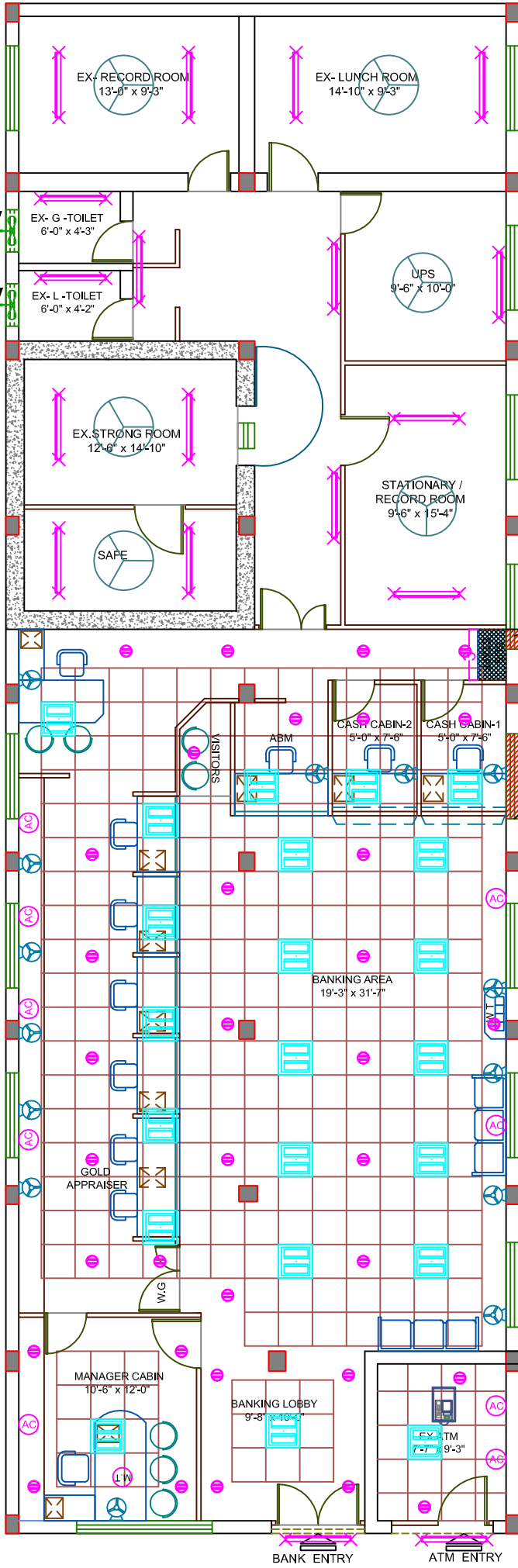

**NOTE:**

1. THIS DRAWING IS THE PROPERTY OF THE ARCHITECT AND SHALL NOT BE COPIED WITHOUT HIS PERMISSION.
2. DISCREPANCIES FOUND IN THE DRAWING SHALL BE BROUGHT TO THE ARCHITECT'S NOTICE IMMEDIATELY.
3. DRAWINGS SHALL BE READ AND SHOULD NOT BE SCALED.

**PROJECT :**

PROPOSED INTERIOR PLAN FOR  
**INDIAN BANK**  
**KONGAREDDY PALLI**  
**BRANCH (CHITTOOR)**  
**TIRUPATI (R.O)**

**PROPOSED ELECTRICAL PLAN**  
**GROUND FLOOR**

**DRG TITLE :**

DESIGNED BY: FA  
 DRAWN BY: Ghayan  
 CHECKED BY : FA  
 DATE : 29-12-2025  
 SCALE : NTS

**NORTH :**

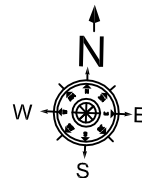

**ARCHITECT:**

**FIROZ AHMED, M.Arch.,**

H.NO 13-6-436/A/33,  
 LAKSHMI APARTMENTS,  
 2nd FLOOR, 301, LAKSHMI NAGAR  
 PILLAR NO.68, MEHIDIPATNAM,  
 HYDERABAD-028.

CELL: 98481 49737

**OPTION - 05**

SOUTH ROAD

S.No.	Item	Item Code	Qty.	Unit	Rate in Rs.	Amount (Rs.)
<b>A</b>	<b>INTERIOR FURNISHING (CONTRACT WORK)</b>					
1	Providing and fixing <b>ENTRANCE DOOR and ENTRANCE PARTITION</b> in beach wood framed glazed door with Patch fitting glazed door shutter using 12mm thk etched Modi float glass /approved make with <b>I.B</b> Logo of 9" dia engraved design border of 8mm thk and with all necessary accessories such as floor springs of dorma make, brushed SS handles (SU12PSS of dorset make of silver bronze finish) fixed to the doors inside & out side, Godrej Mortice lock of brass finish, etc. as directed by Bank / Architect. complete as shown in drawing. (INDIAN BANK logo to be etched on glass as shown in the drg.)	MDP	60.00	Sft		
2	Providing and fixing <b>FULL HEIGHT PARTITION with GLASS</b> in double skin of 9mm thk.BWR grade ply with 1.0mm thk shell finish laminate on both sides fixed to natural melamine polished Beach wood bottom, middle and top rail of 3" x 2" and concealed Salwood verticals of 2" x 2" at not more than 4'-0" apart including fitting door frame where indicated with beach wood frame of 4" x 2" complete as shown in drawing. shall be of natural melamine polished beach wood, above 3'-0" with 6mm plain float glass with etching fixed to 2"x3" beach wood Vertical/ horizontals and 12mmx12mm BW beading, all in natural melamine mate polished, incl. fitting door frame where indicated with beach wood frame of 4" x 2" complete as shown in drawing. (Verticals to go upto the RCC roof for support, but measurement rate shall be made only upto the false ceiling only and shall not incl. the door shutter which is a seperate item).	FHP(G)	201.00	Sft		
3	Providing and fixing <b>FULL HEIGHT PARTITION</b> in double skin of 9mm thk.BWR grade ply with 1.0mm thk shell finish laminate on both sides fixed to natural melamine polished Beach wood bottom, middle and top rail of 3" x 2" and concealed Salwood verticals of 2" x 2" at not more than 4'-0" apart including fitting door frame where indicated with beach wood frame of 4" x 2", complete as shown in drawing. (Verticals to go upto the RCC roof for support, but measurement rate shall be made only upto the false ceiling only and shall not incl. the door shutter which is a seperate item).	FHP	496.00	Sft		
4	<b>LOW HEIGHT with DOUBLE SKIN (4'-0" ht.),as per 2 above,</b> with wood based Assam / Andaman teak wood / equivalent solid wood of 50mm x 50mm (2" x2") verticals @ 600mm to 900 mm (2'-0" to 3'-0" ) intervals spacing should not be more than 600mm (2'-0") intervals) with the skin on both sides made up of 9mm BWR ply wood finish with 1.0mm laminates up to 3'-0" ht & above that 14"ht 6mm thk etched glass fixed to 2"x3" beach wood Vertical/ horizontals and 12mmx12mm BW beading, all in natural melamine mate polished Complete as shown in drawing.	LHP	210.00	Sft		
5	Providing and fixing full height <b>CASH CABIN FRONT PARTITION</b> as in 2 above but with 12mm plane float glass with hole cutting and grinding, corner verticals of natural melamine polished beach wood as per drawing and writing platform of 18mm thk black polished granite slab with edge rounding fixed on 18mm BWR ply with 1.0 mm thk. shell finish laminate, complete as shown in the drawing. (Verticals to go upto the RCC roof for support, but measurement rate shall be made only upto the false ceiling only and shall not incl. the door shutter which is a seperate item).	CCP	275.00	Sft		

S.No.	Item	Item Code	Qty.	Unit	Rate in Rs.	Amount (Rs.)
6	<b>MANGER'S WORKING TABLE (6'-0"x3'-0"):</b> Fabricating manger's Table made out of 18mm commercial ply, having table top 2'-6" height from the ground level & 2'-6" clear top width. Table shall be provided with a sliding keyboard tray 2'-3" wide with slider, 2nos drawers on either sides and cupboard below the drawer locking arrangements, aluminum handles, brass hinges etc all exposed surface shall be laminated with 1.0 mm thk rubber wood laminate. The internal surfaces shall be painted with two coats of enamel paint over a coat of primer. Provision for c.p.u stand 1'-0" x 2'-0" & foot rest of size 75mm x 38mm shall be at bottom .wire manger shall be provided to the counter all exposed edges of the block board shall be provided with teak wood beading and polishing etc, complete. All exposed edges of the block shall be provided with teak wooden beading (3"x1"front side and 1"x 3/4" inner side) and polishing done etc. complete as shown in drawing.	M.T	1.00	Nos.		
7	Providing and fixing <b>CASH CABIN TABLE (5'-0"X3'-0")</b> , and Keyboard to be fixed for every cabin, in 18mm thk. marine comercial ply horizontals above in 20mm thk. black polished granite with edge grinding at nosing done at the corner surfaces fixed on top, front edges of ply to be 2" x 1" thk. TW frame on the outside, polished (1"x 3/4") teak wood moulding / beading to all exposed edges of ply, all internal exposed surfaces of the table to be painted with two coats of synthetic enamel paint on plywood after one coat of primar, complete as shown in drawing, Complete as shown in drawing.	C.T	1.00	Nos.		
8	Providing and fixing <b>OFFICER/ CLERICAL TABLE with out side TABLE of 4'-6" X2'-9"</b> , table made out of 18 mm commercial ply board (approved make )structure with edges fixed with teak wooden lipping ,having officer table top 2'-6" from the ground level & 2'-6" clear top width. it will have a side table of size 1'-6" x 3'-0". Each unit shall be provided with a sliding key board tray 2'-3" of wide with sliders, cupboard below the drawer with locking arrangements aluminum handle, brass hinges etc the front back & top surface shall be laminated with 1.5mm thick rubber wood laminate.The internal surface shall be painted with to coats of enamel paint (VANILLACREAM, CODE -3229) of Asian paints, over a coat of primer. Provision for c.p.u stand 1'-0" x2'-0" & footrest of size 75mmx38mm shall be made at the bottom. Wire manager shall be provided at the corner of the counter top. All exposed edges of the block shall be provided with teak wooden beading (3"x1"front side and 1"x 3/4" inner side) and polishing done etc. complete as shown in drawing.	OT	7.00	Nos.		
9	Front <b>RUNING GLASS FRONT above Curve /stright front Counter</b> as per layout plan (15" ht. with 12mm thk. etched glass) fixed to 3"mm dia TW uprights, with edge rounding and side partition with coping on the top at the every edge of the table. complete as shown in drawing.	RG	27.00	Rft		
10	Providing and fixing <b>GENERAL CUPBOARDS</b> in 18mm thk BWP ply verticals and horizontals with 18mm thk BWP ply shelves with battened shutter in 12mm thk BWP ply with 1.0mm thk shell finish laminate on all external exposed surfaces with shutters fixed with auto closing hinges at not more than 2'-0" apart inclusive all approved accessories like handles, cupboard locks, tower bolts etc.,complete as shown in the drawing. All internal exposed ply surfaces to be painted with two coats of synthetic enamel paint on lappam finished plywood after one coat of primer and all exposed edges of ply to be fixed with TW beading. (Measurement will be made on elevation area of cupboard irrespective of depth)	GC	30.00	Sft		

S.No.	Item	Item Code	Qty.	Unit	Rate in Rs.	Amount (Rs.)
11.a	<b>FALSE CEILING (GRID)</b> : The grid false ceiling shall be provided in the Banking Hall, Manager's etc. Refer drwgs. No. 1-4-8. the ceiling height and level shall be provided at the perimeter. The minimum height of the ceiling cavity should be 100mm. All service fittings integrated within the suspended ceiling must be independently supported from the ceiling grid by a structure designed for the purpose. Ceiling tiles: shall be armstrong fine figured classic lite RH99 of 16mm thickness. Suspension system: shall be of armstrong trulok silhouette reveal profile grid system with 15mm flanges incorporating 3mm central recess in global white with black reveal. silhouette main runners and cross tees to have mitred ends and "birdsmouth" notches to provide mitred cruciform junctions.	GD	1,076.00	Sft		
11.b	<b>a). FALSE CEILING with Painting:</b> Provided & fixing with Indian gypsum or equivalent suspended false ceiling with two coat Luppam and two coat of acrylic emulsion paint. (in any shape as shown in drawing) which includes providing and fixing G.I perimeter channels of 0.55mm thk having one flange of 20mm & another flange of 30mm & a web of 27mm along the perimeter of the ceiling, screw fixed to the brick wall with the help of nylon sleeves & screws, at 610 mm centers. as per manufacturers spec.s, taping of joints and finishing. finally the board are to be jointed and finished so as have a flush lock which includes filling & finishing tapered square edges of the boards with jointing compound, paper tape and with one coat of lappam perfectly to level the surface, complete. complete as shown in drawing.		536.00	Sft		
12	Providing and fixing <b>OFFICER/ CLERICAL TABLE with SIDE TABLE of 5'-0" X2'-9"</b> , table made out of 18 mm commercial ply board (approved make )structure with edges fixed with teak wooden lipping ,having officer table top 2'-6" from the ground level & 2'-6" clear top width. it will have a side table of size 1'-6" x 3'-0". Each unit shall be provided with a sliding key board tray 2'-3" of wide with sliders, cupboard below the drawer with locking arrangements aluminum handle, brass hinges etc the front back & top surface shall be laminated with 1.5mm thick rubber wood laminate.The internal surface shall be painted with to coats of enamel paint (VANILLACREAM, CODE -3229) of Asian paints, over a coat of primer. Provision for c.p.u stand 1'-0" x2'-0" & footrest of size 75mmx 38mm shall be made at the bottom. Wire manager shall be provided at the corner of the counter top. All exposed edges of the block shall be provided with teak wooden beading (3"x1"front side and 1"x 3/4" inner side) and polishing done etc. complete as shown in drawing.	OT	0.00	Nos.		
13	Providing and fixing <b>WALL PANELLING</b> in any shape to columns and walls where indicated with 8mm thk BWR ply fixed to 1" x 2" salwood verticals and horizontals spaced not more than 2'-0" apart in both directions with 1mm thk shell finish laminate upto a height of 3'-6" and texturised "Spectrum" paint finish above after appropriate surface preparation, complete as shown in the drawing.	WP	0.00	Sft		
14	Providing and fixing <b>CHECK DROP/ SUGGESION BOX (1'-2"X1'-2"X1'-6"ht.)</b> in 18mm thick 303 ply, for verticals and horizontals with 1.0mm thk shell finish laminate on all visable outer surfaces with drawer slides incl. all accssories such as handles, auto closing hinges, single key locking system for drawers, complete as shown in the drawing. All exposed ply surfaces to be painted with two coats of synthetic enamel paint on plywood after one coat of primer.	CB	2.00	Nos.		
15	<b>Asst Table/ Sub Staff/ Printer &amp; Lunch (1'-6" Wide)</b> : The counter shall have 19mm BWR boarer free ISI marked ply finished with 1.00mm laminate of approved shade. The top shall be supported brackets. The unit shall be finished with 1.00mm thick laminate of approved shade on all exposed sides and inner sides shall be finished with enamel paint. footrest shall be provided.	AT	6.00	Sft		

S.No.	Item	Item Code	Qty.	Unit	Rate in Rs.	Amount (Rs.)
16	Providing and fixing <b>WRITING TABLE</b> in 18mm thick BWR ply verticals and horizontals with 1.0mm thk shell finish laminate towards exposed side, with 6mm thk plain glass for partition complete as shown in the drawing. All exposed ply surfaces to be painted with two coats of synthetic enamel paint on plywood after one coat of primer.	WT	1.00	Nos.		
17	Providing and fixing water proof solid core <b>FLUSH DOORS</b> shutters 35mm thk (TW wood beading of 0.5" x 1.25" to be provided all around) of approved make as per ISI specifications and 1mm thk shell finish laminate on both sides with vision hole cutting with 6mm thk plain glass as indicated. The shutter shall be fixed to existing partition frame work, necessary hardware fittings like brass butt hinges,door closers, mortice locks, tower bolts, handles etc.of approved make, including all incidental and operational charges etc., complete.	FD	187.00	Sft		
18	Providing and fixing 12 mm th. <b>SOFT BOARD</b> on 12mm th. BWR ply with cloth covering of not less than Rs.250/- per metre, complete incl. painting the rear surface of ply with two coats of synthetic enamel paint and providing TW beading all around.	SB	16.00	Sft		
19	<b>VERTICAL VENETION BLINDS:</b> Providing and fixing 100mm wide vertical blinds of mac make of approved range with louver made of polyester base fabric and providing with guardian tilter wand cord accessories like head channel, end control unit, tilt rod, tilter chain, carrier, space, bottom mechansm, cord, cord weight, instslation, etc; of approved colour and texture. complete as per Bank / Architect direction.	VB	245.00	Sft		
20	<b>Painting to walls with lappam</b> in two coats of Acrylic emulsion paint after appropriate surface preparation of one coat of primer.		550.00	Sft		
21	<b>Painting to walls and ceiling</b> with out lappam in two coats of Acrylic emulsion paint after appropriate surface preparation of one coat of primer.		350.00	Sft		
22	Providing and fixing <b>covering to rolling shutter</b> and shutters for covering electrical panel board, etc., with 18mm BWR ply with 1mm thick shell finish laminate of approved shade and make including painting of inside with primer and two coats of synthetic enamel paint, and providing teak wood beading to all exposed edges including all accessories hinges, handles, ballcatches, etc., complete.	R.S	36.00	Sft		
23	<b>ALLUMINIUM GRILL</b> FOR CASH CABIN TOP	A.G	84.00	Sft		
24	<b>Repairing &amp; Arraging the existing furniture for temporary till the final work</b>	A.G	1.00	LS		
*	<b>TOTAL AMOUNT for BRANCH Interior works (A):</b>					
<b>B</b>	<b>INTERIOR FURNISHING ( ATM WORKS )</b>					
1	Providing and fixing <b>ENTRANCE DOOR and ENTRANCE PARTITION</b> in beach wood framed glazed door with Patch fitting glazed door shutter using 12mm thk etched Modi float glass /approved make with <b>IB</b> Logo of 9" dia engraved design border of 8mm thk and with all necessary accessories such as floor springs of dorma make, brushed SS handles (SU12PSS of dorset make of silver bronze finish) fixed to the doors inside & out side, Godrej Mortice lock of brass finish, etc. as directed by Bank / Architect. complete as shown in drawing. (INDIAN BANK logo to be etched on glass as shown in the drg.)	MDP	60.00	Sft		

S.No.	Item	Item Code	Qty.	Unit	Rate in Rs.	Amount (Rs.)
2	<b>FALSE CEILING (GRID)</b> : The grid false ceiling shall be provided in the Banking Hall, Manager's etc. Refer drwgs. No. 1-4-8. the ceiling height and level shall be provided at the perimeter. The minimum height of the ceiling cavity should be 100mm. All service fittings integrated within the suspended ceiling must be independently supported from the ceiling grid by a structure designed for the purpose. Ceiling tiles: shall be armstrong fine figured classic lite RH99 of 16mm thickness. Suspension system: shall be of armstrong trulok silhouette reveal profile grid system with 15mm flanges incorporating 3mm central recess in global white with black reveal. silhouette main runners and cross tees to have mitred ends and "birdsmouth" notches to provide mitred cruciform junctions.	GD	76.00	Sft		
3	Providing and fixing <b>WALL PANNELLING</b> in any shape to columns and walls where indicated with 8mm thk BWR ply fixed to 1" x 2" salwood verticals and horizontals spaced not more than 2'-0" apart in both directions with 1mm thk shell finish laminate upto a height of 3'-6" and texturised "Spectrum" paint finish above after appropriate surface preparation, complete as shown in the drawing.	WP	0.00	Sft		
4	Providing and fixing <b>FULL HEIGHT PARTITION</b> in double skin of 9mm thk.BWR grade ply with 1.0mm thk shell finish laminate on both sides fixed to natural melamine polished Beach wood bottom, middle and top rail of 3" x 2" and concealed Salwood verticals of 2" x 2" at not more than 4'-0" apart including fitting door frame where indicated with beach wood frame of 4" x 2", complete as shown in drawing. (Verticals to go upto the RCC roof for support, but measurement rate shall be made only upto the false ceiling only and shall not incl. the door shutter which is a seperate item).	FHP	0.00	Sft		
5	<b>Painting to walls with lappam</b> in two coats of Acrylic emulsion paint after appropriate surface preparation of one coat of primer.		140.00	Sft		
6	<b>Painting to walls and ceiling</b> with out lappam in two coats of Acrylic emulsion paint after appropriate surface preparation of one coat of primer.		0.00	Sft		
7	Providing and fixing <b>covering to rolling shutter</b> and shutters for covering electrical panel board, etc., with 18mm BWR ply with 1mm thick shell finish laminate of approved shade and make including painting of inside with primer and two coats of synthetic enamel paint, and providing teak wood beading to all exposed edges including all accessories hinges, handles, ballcatches, etc., complete.	RS	36.00	Sft		
<b>B</b>	<b>TOTAL AMOUNT for ATM Interior works (B):</b>					
<b>A+B</b>	<b>TOTAL AMOUNT for Interior Branch &amp; ATM contract work (A + B):</b>					
*	<b>Rupees</b>					
	<b>GST EXTRA (18%)</b>					