

COPYRIGHT:
All rights reserved. This work is copyright and cannot be reproduced or copied in any form or by any means (graphic, electronic or mechanical, including photocopying) without the written permission of Nanda & Associates. Any license, express or implied, to use the document for any purpose whatsoever is restricted to the terms of the agreement or implied agreement, with Nanda & Associates.



LEGEND:-

	- Gypsum Board False Ceiling
	- Grid False Ceiling

FALSE CEILING AREA STATEMENT

SI.NO	DESCRIPTION	AREA IN (Sq. Ft)
01	MANAGER CABIN	119.00
02	BANKING HALL	928.00
03	ATM AREA	100.00
TOTAL		1047.00

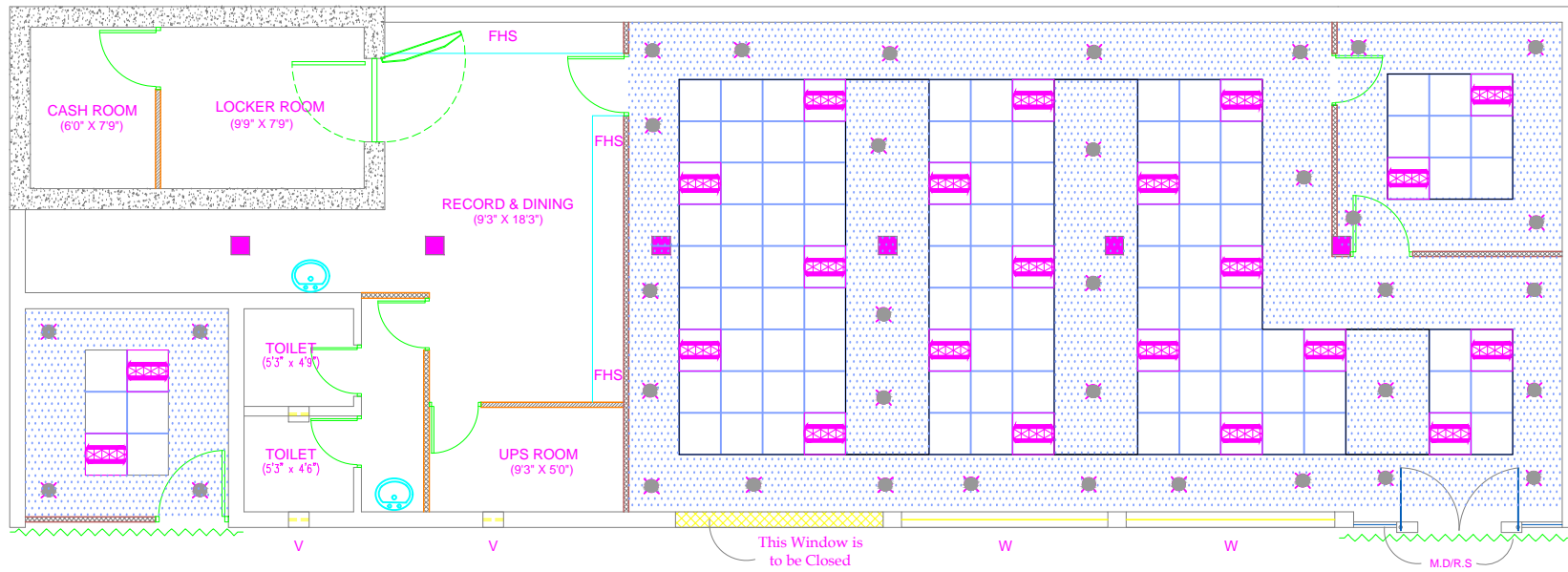

CLIENT:
**M/S INDIAN BANK,
CHENNAI NORTH ZO**

PROJECT :
**PROPOSED FALSE CEILING
ENHANCEMENT FOR INDIAN BANK AT
PERAMBUR BRANCH , CHENNAI NORTH
ZO.**

DRAWING TITLE :
SCHEMATIC DRAWING

- | | |
|--|---|
| <input type="checkbox"/> SCHEMATIC DRAWING | <input checked="" type="checkbox"/> WORKING DRAWING |
| <input type="checkbox"/> TENDER DRAWING | <input type="checkbox"/> AS BUILT DRAWING |

SCALE : N.T.S DATE: 06/05/2025 REV NO: 00

DRAWN BY : DJ VJAJY CHECKED BY: MS

JOB NO : 3214/26 DWG NO :

ARCHITECT :
 **NANDA & ASSOCIATES
ARCHITECTS**

NO.36, SARASWATHI ILLAM, JANAKIRAM COLONY MAIN RD,
JANAKIRAM COLONY , ARUMBAKKAM , CHENNAI - 600 106.
TELEPHONE:044-23637420,E-mail:nandaarchitects@gmail.com