

COPYRIGHT:
All rights reserved, this work is copyright and cannot be reproduced or copied in any form or by any means (graphic, electronic or mechanical, including photocopying) without the written permission of nanda & associates. Any fence, express or implied, to use the document for any purpose whatsoever is restricted to the terms of the agreement or implied agreement, with nanda & associates

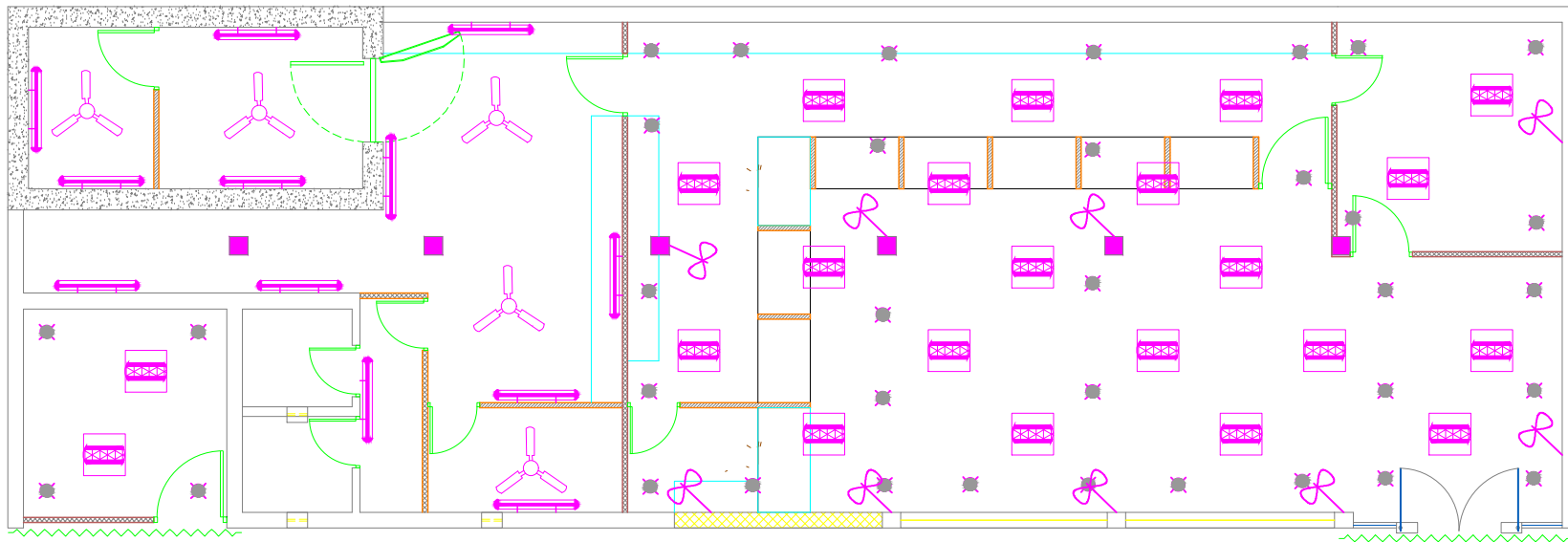

- BOX TYPE FITTING 1X36W (WALL)
- BOX TYPE FITTING 1X36W (CEILING)
- 1X13 W CFL LIGHTER
- CEILING FAN 48" Dia
- HOARDING/NAME BOARD LIGHT
- WALL MOUNT FAN 16" Dia
- 2 Nos 6A PLUG SOCKET & (RAW)
- 4 NOS 6A PLUG SOCKET (UPS)
- 12" EXHAUST FAN
- 2/2 MIRROR OPTICAL
- 1 X 13 W CFL DOWN LIGHTER
- TELEPHONE POINT
- DISTRIBUTION BOARD
- UPS DB
- MAIN PANEL
- METAL ENCLOSURE
- MEGA SPLIT TYPE AC UNIT (3 TON)



CLIENT:
**M/S INDIAN BANK,
CHENNAI NORTH ZO**

PROJECT :
**PROPOSED ELECTRICAL
ENHANCEMENT FOR INDIAN BANK AT
PERAMBUR BRANCH , CHENNAI NORTH
ZO.**

DRAWING TITLE :
SCHEMATIC DRAWING

- SCHEMATIC DRAWING WORKING DRAWING
- TENDER DRAWING AS BUILT DRAWING

SCALE : N.T.S DATE: 06/05/2025 REV NO: 00

DRAWN BY : DJ VJAY CHECKED BY: MS

JOB NO : 3214/26 DWG NO :
ARCHITECT :

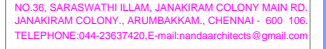

NO.36, SARASWATHI ILLAM, JANAKIRAM COLONY MAIN RD,
JANAKIRAM COLONY, ARUMBAKKAM, CHENNAI - 600 106.
TELEPHONE:044-23637420,E-mail:nandaarchitects@gmail.com